

Faculty of Engineering  
Civil Engineering Department

Surveying lab  
ENCE316

Experiment no. 9  
Mapping using total station

Done by group C :

Hussam Abualrob 1180894  
Omar Barham 1182171  
Firyal Dajani 1181124  
Jolan Asmar 1180959

Date : 09/02/2021

Units : Meter

Scale : 1:100

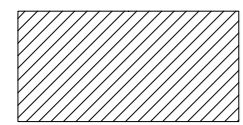

Building

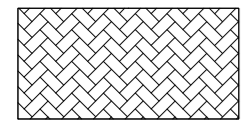

Tiles

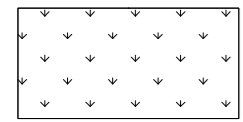

Flowers/Grass

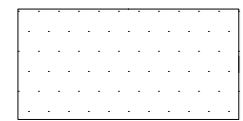

Asphalt

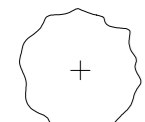

Tree

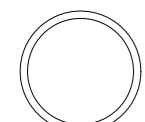

Manhole

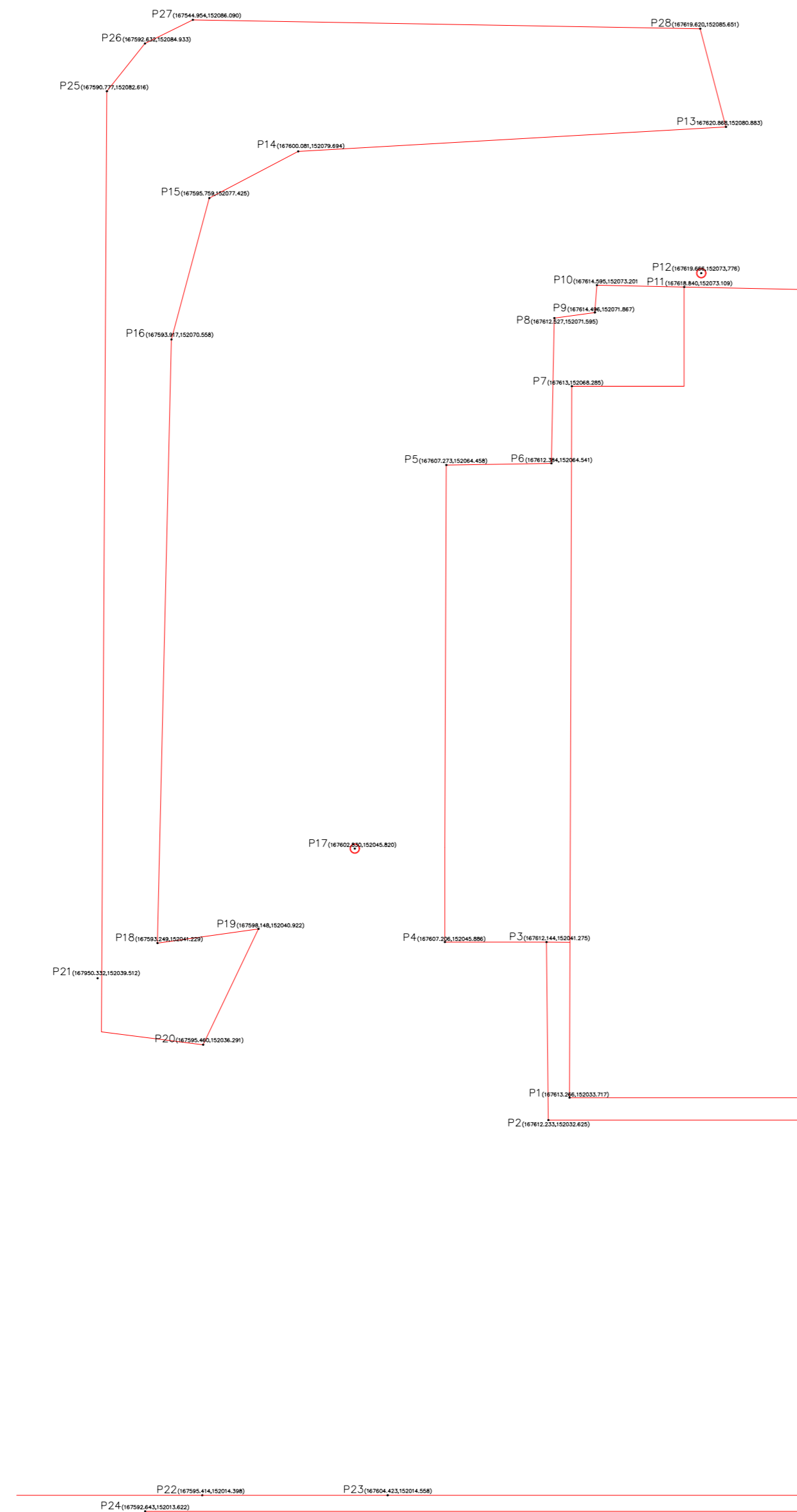

Points & Lines

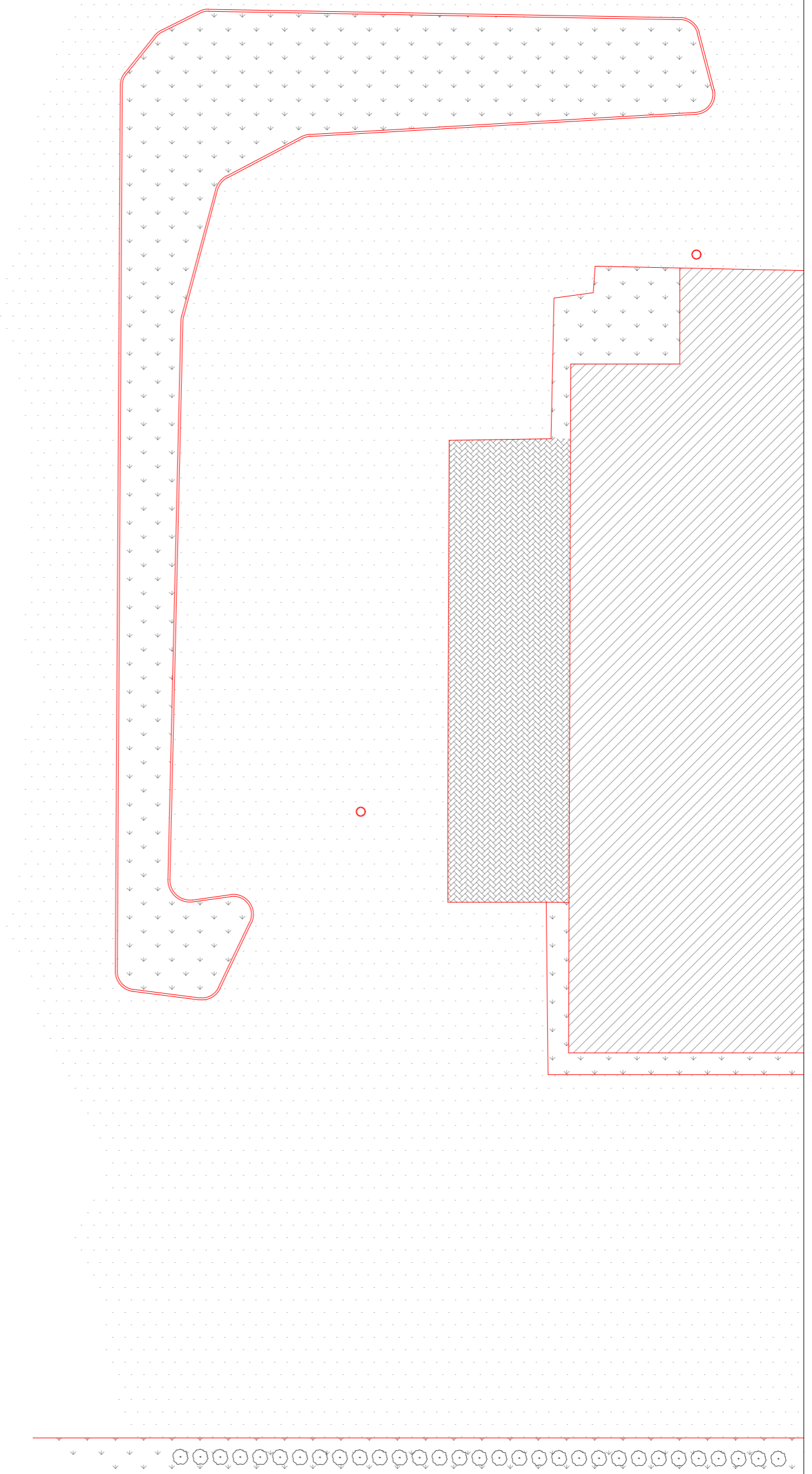

Realistic & Refined