



**Al-Zaytoonah Private University of Jordan**

**Faculty of Engineering/Civil Engineering Department**

**CE 902573 Specifications and Quantity Surveying - 3 credits**

# **Quantity Surveying**

## **Class Notes**

**By**

**Dr. Hesham Ahmad**

**First Edition**

## Table of Contents

<b>Table of Contents</b> .....	<b>I</b>
<b>Chapter 1: Introduction</b> .....	<b>1</b>
1.1 Definition of Quantity Survey.....	1
1.2 Data Required for the Preparation of an Estimate or Quantity Survey .....	1
1.3 Importance of Quantity Survey .....	2
1.4 Types of Estimates and Quantity Survey.....	2
1.5 Contracts .....	3
1.5.1 Obligations of the employer (المالك).....	3
1.5.2 Obligations of the Contractor (المقاول).....	3
1.5.3 Role of the Engineer (الإستشاري أو الإشراف) .....	4
1.6 Types of Contracts.....	5
1.6.1 Measured or Unit rate Contract .....	5
1.6.2 Lumpsum contract .....	6
1.6.3 Cost-plus contract .....	6
1.6.4 Construction Management Contract (C.M.).....	7
<b>Chapter 2: Quantity Survey Items and Methods</b> .....	<b>8</b>
2.1 Introduction .....	8
2.2 Bill of Quantities BOQ (جداول الكميات) .....	9
2.3 Excavation (أعمال الحفريات).....	10
Swell and Compaction .....	10
Cross-section Method (Grid Method) .....	11
Cut and Fill with Paving.....	19
Simple Grid Method .....	20
2.4 General Excavation.....	21
Basement Excavation.....	21
Continuous Footing Excavation .....	23
Spread Footing Excavation .....	24
2.5 Backfilling (أعمال الردم) .....	25
Backfilling the Basement Walls .....	25
Backfilling the Continuous Foundations .....	26
2.6 Concrete Works (أعمال الخرسانة) .....	28
Jordanian Specifications.....	28
Examples.....	29
2.6.1 Blinding (خرسانة النظافة).....	30
2.6.2 Concrete of Footings (خرسانة الأساسات).....	31
2.6.3 Concrete of Slabs(خرسانة العقدات).....	33
2.7 Steel Reinforcement(أعمال حديد التسليح).....	35
2.8 Plastering (أعمال القسارة).....	39
2.9 Bricks (أعمال الطوب) .....	42
2.10 Masonry Work (أعمال الجدران الحجرية).....	46

# Chapter 1: Introduction

## 1.1 Definition of Quantity Survey

Quantity survey is a schedule of quantities of all the items of work in a building.

## 1.2 Data Required for the Preparation of an Estimate or Quantity Survey

### 1.2.1 Drawings

Complete and fully dimensioned drawings (i.e. plans, elevations, sections and other details) of the building or work in question are required.

### 1.2.2 Specifications

Detailed specifications, giving the nature, quality and class of work, materials to be used, quality of the material, their proportions, and method of preparation are required.

### 1.2.3 Rates

The rates of various of work, materials to be used in the construction, wages of different categories of labor (skilled or unskilled) and cost of transportation charges should be available for preparing an estimate of work cost.

### 1.2.4 Actual Finished Work

Quantities can be calculated from the actual work done in the project site.

- The quantities mainly can be calculated as:

Quantity = Length  $\times$  Width  $\times$  (Height or Thickness),

Quantity = Area of cross-section  $\times$  Length,

Quantity = Length  $\times$  Width,

Quantity = Length.

Quantity = Number of Units.

Quantity = Weight.

### 1.3 Importance of Quantity Survey

1. Quantity survey is essential to estimate before the construction starts the *probable cost* of construction for the complete work. The construction cost includes cost of materials, cost of transportation, cost of labor, cost of scaffolding, cost of tools and plants, establishment and supervision charges, cost of water, taxes and reasonable profit of the contractor, etc. The estimate is required in inviting tenders for the works and to arrange contract for a complete project.
2. Quantity survey is required to estimate the quantities of the various materials required and the labor involved for satisfactory completion of a construction project.
3. It is also useful to check the works done by contractors during and after the execution. Also the payment to the contractor is done according to the actual measurements of the completed part of each item of work.
4. A complete quantity survey or estimate is useful to provide useful advice to clients on:
  - (i) Valuation of properties (land and building) for sale, purchase and mortgage etc.
  - (ii) Fixation of standard rent.
  - (iii) For insurance and claim for damages in a building.
  - (iv) For the process of resolving disputes by referring to a third party.

### 1.4 Types of Estimates and Quantity Survey

#### 1.4.1 Preliminary or Approximate Estimate

This is to find out an approximate cost in a short time. It is used to give an idea of the cost of a proposed project. This estimate helps the client or sanctioning authority to make decision of the administrative approval.

The approximate cost is prepared from the comparison with similar works. The approximate cost can be found by using methods that depends on the area or cubic content of a building and then multiplying this by an estimated rate for the unit of the area or cubic content. Approximate quantities of materials and labor required per m<sup>2</sup> of the area for a proposed building also can be found.

#### 1.4.2 Detailed Estimate

After getting the administrative approval, this estimate is prepared in detail prior to inviting of tenders. The whole project is divided into sub-works, and the quantities of each sub-work are calculated separately. The dimensions of the required work are taken from the drawings of the project.

#### 1.4.3 Quantity Estimates

This is a complete estimate of quantities for all items during project implementation.

#### 1.4.4 Revised Estimate

Prepared if the estimate exceeded by 5% due to the rates being found insufficient or due to some other reason.

#### 1.4.5 Maintenance Estimate

Estimating required quantities and cost of work to maintain a structure (road, building, etc.)

## 1.5 Contracts

Contract is an agreement between two or more parties creating obligations (التزامات) that are enforceable or recognizable at law (ملزمة و معترف بها قانونياً)

It establishes an obligation of each party (حزب، فريق، جهة) to fulfill what it is agreed to perform.

### 1.5.1 Obligations of the employer (المالك)

1. Appointing of the engineer to administer the contract
2. Provision of the site
3. Provision of information, permits, and approvals
4. Providing funds and making payments in accordance with the contract
5. Participation in consultations with the engineer to agree matters on claims or conflicts between parties.

### 1.5.2 Obligations of the Contractor (المقاول)

1. Execution and completion of the works and remedying (يعالج) any defects (عيوب) therein.
2. Provision of (يجب على المقاول توفير ما يلي):
  - a. Labor, materials, plant, and equipment needed
  - b. Preparation of progress report
  - c. Works program for execution, and updating it whenever required
  - d. Setting out of the works
  - e. Measurement and/or assisting the engineer to do so
  - f. Records of his personnel and equipment
  - g. Sample of materials specified
  - h. Testing and re-testing
  - i. Temporary works
  - j. Facilities for other contractors working on the site
  - k. Keeping the site clean, and remove rubbish
3. The contractor is required to:
  - a. Sign the contract when he is called to do so
  - b. Obtain and submit securities, guarantees, and insurance policies
  - c. Ensure that his representatives will be available on site at all times

- d. Prepare and submit the contractor's document, including "as built drawings" and manuals of operation and maintenance
  - e. Attend to the engineer's instructions
  - f. Provide access to the employer's personnel to enter the site
  - g. Prepare and submit payment statement and documentation
  - h. To uncover works for inspection when required
  - i. Rectify (Correct) defective works
  - j. Secure or compensate the employer against any claims
  - k. Submit notices to the engineer whenever he encounters circumstances that may cause future claims
  - l. Getting approval before assigning sub-contractors or partners of the works
  - m. Respond for consultation with the engineer
4. Comply with the applicable laws, labor law and other local regulations.

### **1.5.3 Role of the Engineer (الإستشاري أو الإشراف)**

Usually the employer will enter into a consultancy agreement with the engineer to design and/or supervise the works.

The engineer shall have no authority to amend the contract.

Engineer role can be:

1. As the employer's agent:

a. Administration of the contract – dealing with the procedures, provision of information and interpretations, issuance of variations, approval of samples, etc.

b. Cost accountancy and payments

2. As a supervisor:

The engineer must ensure that the work is being performed to fulfill the contract documents.

3. As a certifier:

The engineer is required to certify or approve the payments that should be paid by the employer to the contractor. Those payments should be made periodically, mostly on monthly basis, and should depend on the quantity of works finished by the contractor.

4. As a determiner:

The engineer must act as a mediator to help the parties towards agreement in issues such as claims for reimbursement of costs (تعويضات مالية) or extension of time (تمديد وقت المشروع).

## 5. Issuance of instructions and variations (إصدار التعليمات و التعديلات):

Include: issuance of additional or modified drawings, actions in relation to defective works, issuance of clarifications, giving approval, and ordering variations.

## 1.6 Types of Contracts

### 1.6.1 Measured or Unit rate Contract

In this type of contract, the price is computed by multiplying quantities of work executed by the unit rate offered by the contractor in his tender. The rates are usually set out in the Bill of Quantities (BOQ).

Such contracts often used where there are significant changes in the quantities or working conditions. So, when there are certain reasonable differences of the quantities accepted by all the parties, then the contract can be paid for by multiplying the actual measured quantities by the unit rates.

#### Advantages:

1. Suitability: This type of contract is widely used in the execution of large projects financed by public bodies or governments. It also suits the works which can be split into separate items and the quantity of each item could be estimated with reasonable accuracy.
2. The employer pays for the actual work executed.
3. The contractor usually allows for a certain margin of variation, with a clear mechanism for valuation of such variations.
4. The engineer / employer has liberty to provide some drawings during the execution of the project, after award.

#### Disadvantages:

1. The employer cannot be absolutely sure of the total cost of the project until the whole work is completed. In case the quantities in the BOQ are inaccurate or roughly approximated, the value of the work may vary considerably. The contractor may try to offer an unbalanced tender on the basis of his anticipation of the uncertainty of quantities of certain items.
2. Both the engineer and the contractor have to do considerable computations and book-keeping during the progress of work.
3. Extra works or varied items of work are often a source of conflict. The contractor may press for higher rates than he would have tendered for in the beginning.

### **1.6.2 Lumpsum contract**

In a lumpsum contract, the contractor agrees to carry out the entire work as indicated in the drawings and described in the specifications, for a specified fixed lumpsum amount.

Sometimes, the contract makes provisions to adjust the “lump sum” allowing for extra work and limited variations.

Normally, a bill of quantities is not usually included, and if included it does not form part of the "Contract Documents", but may be used just for guidance.

Instead, a schedule of rates may be of value to evaluate the cost of extras or omissions.

#### Advantages:

1. From the employer's stand point, and if no extras are contemplated, the tender sum tells him the exact cost of the project. Sometimes the employer will be working within a tight margin of budget.
2. From the contractor's stand point, because the design will often be prepared by him, the contractor can gain through proper planning and efficient management to increase his margin of profit and/or to control timing.
3. Both parties need less number of staff for book-keeping (عملية مسك الدفاتر أي تسجيل جميع المعاملات المحاسبية), accounting and measurement.

#### Disadvantages:

1. In lumpsum contracts, there should be a complete set of plans and specifications, or what is called "Employer's Requirements" which should be sufficiently detailed.
2. Variations in lumpsum contract may trigger conflicts about whether or not a particular item of work falls within the agreed scope of work, and whether there has been a variation to such scope.
3. This type of contract will not be suitable for works with scope and nature that cannot be predicted accurately in advance. The outcome will be unfair for the contractor to assume all risks and uncertainties, or for the employer to pay a higher cost.

### **1.6.3 Cost-plus contract**

This type of contract differs from both the measured and the lumpsum contract in that the employer agrees to pay the contractor for the actual cost of the work plus an agreed percentage of this actual cost to cover overhead and profit.

The contractor agrees to execute the works based on the drawings and specifications and any other information that will be provided to him from time to time during progress of the works.

The percentage to be paid should not be applied on the costs of salaries of the contractor's staff, whether on-site or off-site.

#### Advantages:

1. Early completion of the work - The work can be started even before the design and estimates are prepared. Decisions can be taken speedily, and flexibility allows adoption of alternates for construction to suit the Employer's Requirements.



2. The quality of the work can be assured. The contractor is induced to perform the work in the best interest of the employer.
3. No conflicts will be anticipated as to extras or omissions.

Disadvantages:

1. The final cost to the employer cannot be foretold.
2. Both parties have to do a lot of accounting and book-keeping regarding labour; purchase of materials and plant and use of equipment.
3. The contractor has no incentive to economize or finish the work speedily.

Suitability:

In spite of some drawbacks in certain cases, this form of contract can be used suitably for:

- a- Emergency works that require speedy construction and where no time is available to prepare drawings for it.
- b- Construction of special or expensive projects, such as palaces, where the cost of the work is of no consequence but the materials and workmanship to be purchased are just to suit the choice and taste of the employer.

Remark:

An alternate to the cost-plus contract is the cost-plus fixed fee contract, where the contractor will be paid for the actual cost of construction plus a fixed amount of fees for his overhead and profit. The fee does not fluctuate with the actual cost of the project. This factor may overcome the possible drawback of the cost-plus contract.

#### ***1.6.4 Construction Management Contract (C.M.)***

In this type of contract, the employer engages a specialized construction manager (C.M.) to provide administrative service for him and manage the work on his behalf. The (C.M.) has full control on (Cost and Time), on the budget and programming, and is usually paid on a staff-reimbursement basis.

The (C.M.) assists in choosing the design consultant and the various contractors for a project divided into packages (structural, finishes, electro-mechanical, etc.).

The technical role is kept with the design-professional, but as to control, coordination, certification and dispute resolution, the (C.M.) normally possesses the major role.

## Chapter 2: Quantity Survey Items and Methods

### 2.1 Introduction

Quantity surveying and the estimated quantities of materials required on a project are normally determined by professional surveyor or engineer.

The estimated quantities are provided to the interested bidders on a project to provide their prices. In this method of bidding, the contractors are all bidding on the same quantities. The estimators of contractors spend time developing the unit price of the different items in a project. To win the bid, contractors will work on keeping the cost of purchasing and installing the materials as low as possible.

As the project is built, the actual quantities are checked against the estimated quantities. For example, if the estimated quantity of concrete for a wall is  $23 \text{ m}^3$ , but the actual installed concrete is  $26 \text{ m}^3$ , then the contractor would be paid for the additional  $3 \text{ m}^3$ .

When there is a large difference between the estimated and actual quantities, an adjustment to the unit price can be made. Small adjustments are usually made at the same unit as the contractor bid. Large errors may require that the unit price be renegotiated.

If the contractor is aware of potential changes between the estimated quantities and those that will be required in the project, the contractor may price his or her bid to take advantage of this situation. For example, if the contractor is aware that the filling material in the project will be changed from excavated soil to base-course, then he can provide low unit price for filling with excavated soil (say  $5 \text{ JD/m}^3$ ) and high unit price for the base-course (say  $15 \text{ JD/m}^3$ ). If the back-fill quantities were assumed to be  $2000 \text{ m}^3$  of soil and  $100 \text{ m}^3$  of base-course, so the assumed total price as in the bid will be  $11,500 \text{ JD}$ . But if the quantities were changed to  $100 \text{ m}^3$  of soil and  $2000 \text{ m}^3$  of base-course, then the new price of the actual work because of this change will be  $30,500 \text{ JD}$ , which will provide more profit to the contractor.

## 2.2 Bill of Quantities BOQ (جداول الكميات)

المشروع: مبنى كلية الهندسة / جامعة الزيتونة							
المبلغ		السعر		الكمية	وحدة الكيل	نوع العمل	الرقم
دينار	فلس	دينار	فلس				
						<p>يمثل هذا الجدول جدولاً نموذجياً للكميات للأعمال المدنية و المعمارية و الميكانيكية و الكهرباء.</p> <p>وقد تم اعتماد المواصفات العامة الصادرة عن وزارة الأشغال العامة و الإسكان كأساس لأعمال هذا الجدول حيث تم تبويب الأعمال و الإشارة إلى مواصفاتها حسب المواصفات العامة في المجلدات الأول و الثاني و الثالث للأعمال المدنية و المعمارية و الكهربائية و الميكانيكية على التوالي و الصادرة عن وزارة الأشغال العامة سنة 1996.</p> <p>أما الأعمال التي لم يشر إليها بأرقام بنود فهي تعتبر أعمالاً تقع ضمن المواصفات الخاصة و تنفذ حسب المواصفات التي وضعت لها في هذا الجدول أو المواصفات الخاصة.</p> <p>كما تم اعتماد المواصفات القياسية الأردنية الصادرة بعد 1985 كأساس أيضاً لأعمال هذا الجدول حيث تم الإشارة إلى رقم المواصفة الأردنية و سنة صدورها و يجب على المقاول و المشرف الرجوع إليها عند ورودها ضمن الأعمال.</p>	<b>تمهيد</b>

## 2.3 Excavation (أعمال الحفريات)

### *Swell and Compaction*

Excavation is measured by cubic meter, foot or yard. When ground materials are excavated, they expand to a larger volume. When these materials are placed and compacted on a project, they will be compressed into smaller volume than when it was loose. The following table shows common expansion and shrinkage factors for various types of soils related to its natural condition.

Percentage of expansion & Shrinkage		
Material	Swell	Shrinkage
Sand and Gravel	10 to 18 %	85 to 100%
Loam	15 to 25 %	90 to 100 %
Dense Clay	20 to 35 %	90 to 100 %
Solid Rock	40 to 70 %	130 %

Compacted Volume = Natural Volume X Shrinkage

Loose Volume = Natural Volume X (1 + Swell)

---

#### **Example:**

If 100 bank cubic meter (in place at natural density) of dense clay (30% swell) needs to be moved away, how many loose cubic meters have to be moved away by trucks? And, how many loads of 8 m<sup>3</sup> dump trucks will be needed?

#### **Answer:**

Volume of loose clay= 100 X (1+ 0.3) = 130 m<sup>3</sup>

Loads = 130 ÷ 8 = 16.25 (17 truck-loads will be required)

---

#### **Example:**

If (20m x 50m x 20cm) 200 m<sup>3</sup> of compacted sand is required in-place, how many of 8 m<sup>3</sup> loads would be required? The sand has a swell of 15% and shrinkage of 95%.

#### **Answer:**

Compacted Volume = Natural Volume X Shrinkage

Loose Volume = Natural Volume X (1 + Swell)

Natural Volume = 200 m<sup>3</sup> ÷ 0.95 = 210.5 m<sup>3</sup>

Loose Volume = 210.5 m<sup>3</sup> X (1 + 0.15) = 242.1 m<sup>3</sup>

Number of Loads = 242.1 ÷ 8 = 30.26 (31 truck-loads will be required)

---

### Cross-section Method (Grid Method)

Every project site requires cutting and filling to reshape the grade. For any new project, site needs earthwork or grading to remove topsoil or rough ground. Cutting consists of bringing the ground to lower level by removing earth. Filling is bringing soil in to build the land to higher elevation.

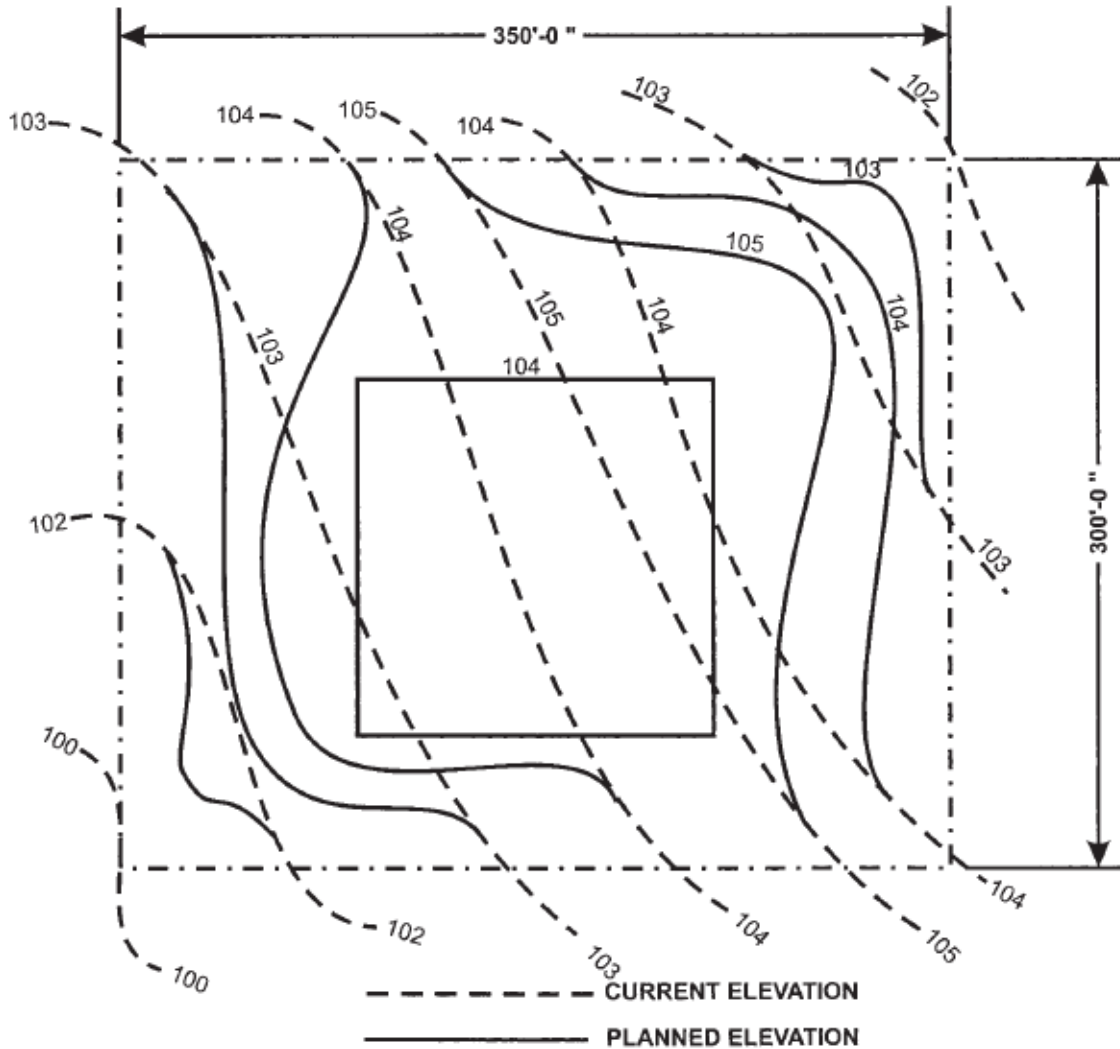

FIGURE 9.3. Sample Site Plan.

The primary drawing for site excavation is the site plan. It shows contour lines that connect points of equal elevation. Also, it shows the position of the site, as shown in the previous figure. In the figure, the existing elevations are shown with dashed contour lines while the proposed new elevations are denoted with solid lines. The new proposed contour lines will change the site area into a level area at elevation 104.

Cross-section method entails dividing the site into a grid and then determining the cut and fill for each of the grids. The size of the grid should be a function of the site, the required changes, and the required level of accuracy. The following figure shows the site divided into 50-foot grid in both directions.

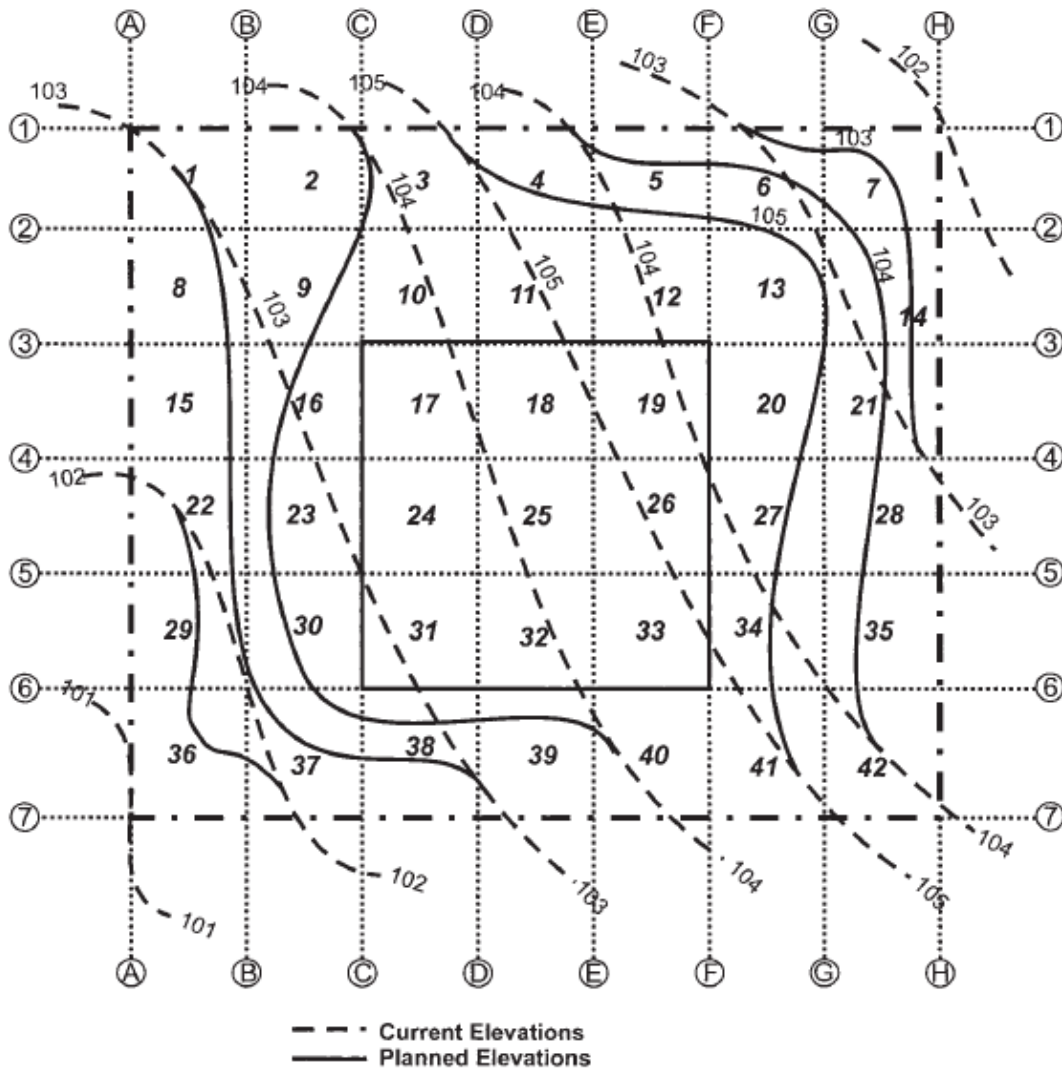

FIGURE 9.4. Site Plan Divided into 50' Square Grid.

The next step is to determine the approximate current and planned elevation for each grid line intersection. The following figure shows the labeling method that should be used for this process.

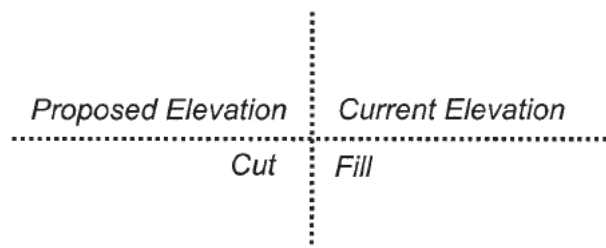

FIGURE 9.5. Labeling Convention.

Because contour lines rarely cross the grid intersection, it is necessary to estimate the current and proposed elevations at each of the grid intersection points. If the proposed elevation is greater than the current elevation, fill will be required. Conversely, if the planned elevation is less than the current elevation, cutting will be needed. Then, the grids that contain both cut and fill should be examined by checking the corners of the individual grid boxes. In the figure these are grids 3, 4, 10, 11, 12, 17, 18, 19, 25, 27, 32, 34, 39, and 41.

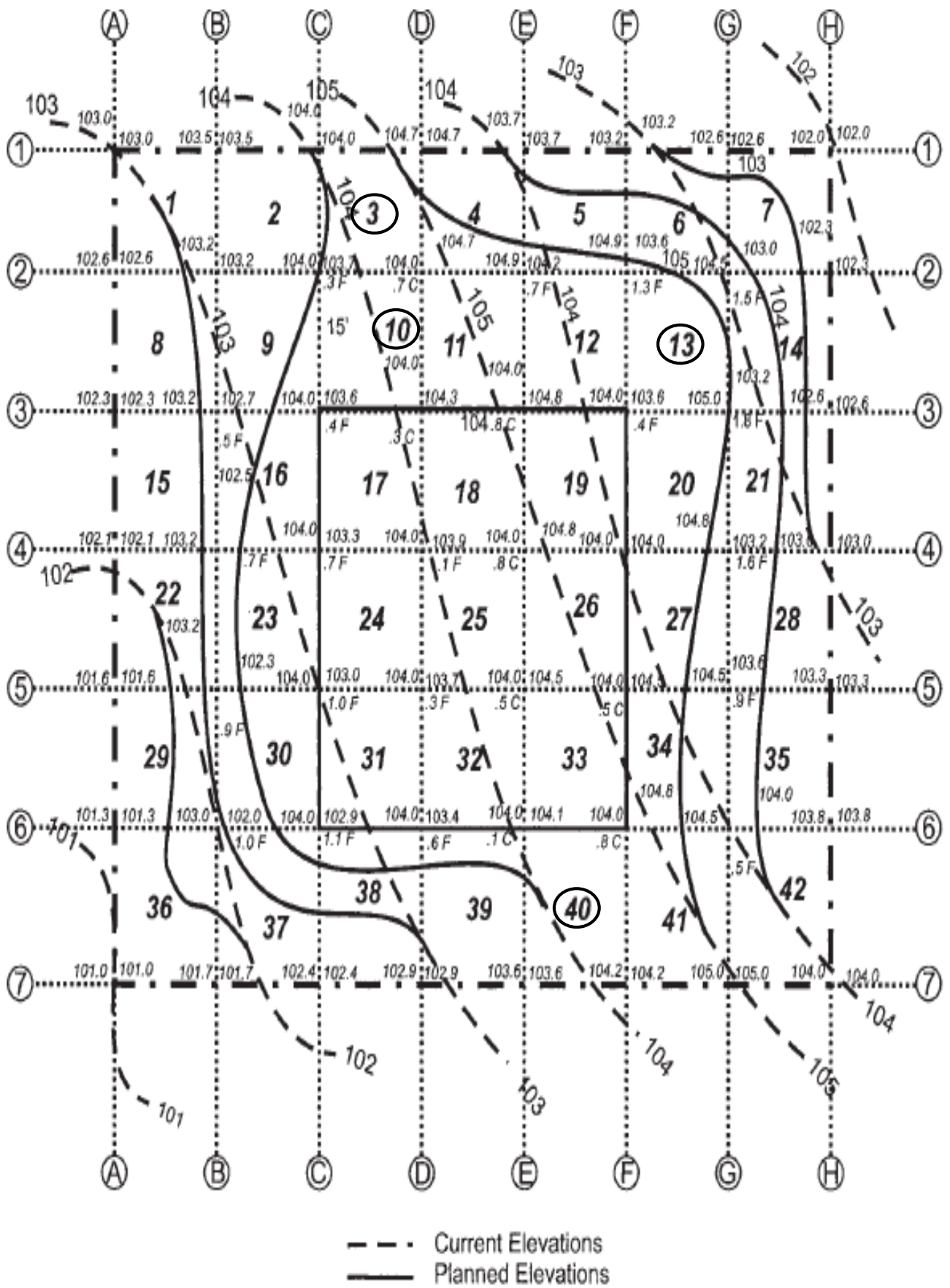

FIGURE 9.6. Grid with Elevations.

**EXAMPLE 9-4 FILL VOLUME**

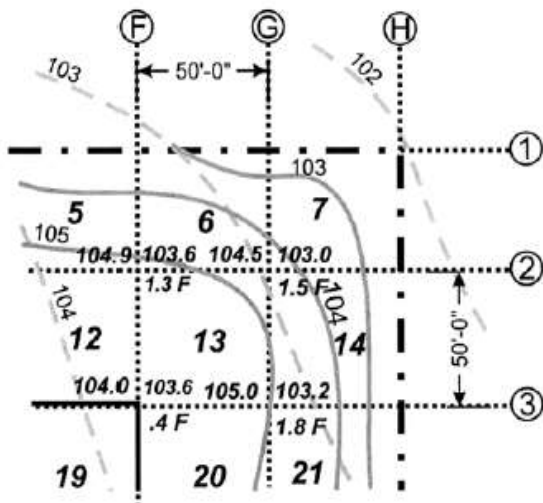

FIGURE 9.7. Excerpt of Grid 13.

Using grid 13 (Figure 9.7) from Figure 9.6 as an example, determine the fill quantity. From Figure 9.7, the information in Figure 9.8 is known about grid 13.

$$\text{ccf of fill} = \frac{\text{Sum of fill at intersections}}{\text{Number of intersections}} \times \text{Area}$$

$$\text{ccf of fill} = \frac{1.3' + 1.5' + 0.4' + 1.8'}{4} \times 2,500 \text{ sf}$$

$$= 3,125 \text{ ccf of fill}$$

That amount of fill is then entered in the fill column of the cut and fill worksheet (Figure 9.16).

Point	Planned Elevation	Existing Elevation	Fill (ft.)
F2	104.9'	103.6'	1.3
G2	104.5'	103.0'	1.5
F3	104.0'	103.6'	0.4
G3	105.0'	103.2'	1.8

FIGURE 9.8. Data for Grid 13.

**EXAMPLE 9-5 CUT VOLUME**

The volume of cut is determined in exactly the same fashion for cuts as fills. The information in Figure 9.9 is known from using grid 40; as an example (Figure 9.10), the following information is known.

$$\text{bcf of cut} = \frac{0.1' + 0.8' + 0' + 0'}{4} \times 2,500 \text{ sf} = 563 \text{ bcf cut}$$

That amount of cut is then entered in the cut column on the cut and fill worksheet (Figure 9.16).

Point	Planned Elevation	Existing Elevation	Cut (ft.)
E6	104.0'	104.1'	0.1
F6	104.0'	104.8'	0.8
E7	103.6'	103.6'	0.0
F7	104.2'	104.2'	0.0

FIGURE 9.9. Data for Grid 40.

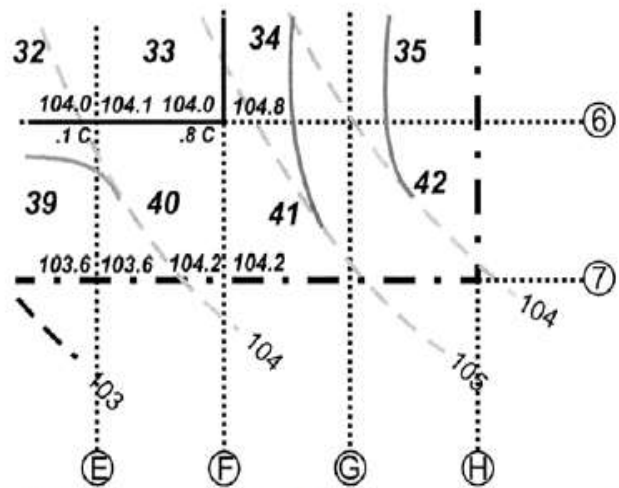

FIGURE 9.10. Excerpt of Grid 40.

When a specific grid contains both cut and fill, that grid needs to be divided into grids that contain only cut, only fill, or no change. These dividing lines occur along theoretical lines that have neither cut nor fill. These lines of no change in elevation are found by locating the grid sides that contain both cut and fill. Theoretically, as one moves down the side of the grid, there is a transition point where there is neither cut nor fill. These transition points, when connected, develop a line that traverses the grid and divides it into cut and fill areas and, in some instances, areas of no change.



**EXAMPLE 9-6 CUT AND FILL IN THE SAME GRID**

Grid 10 (Figure 9.11) from Figure 9.6 is an example of a square that contains both cut and fill. Along line 2, somewhere between lines C and D, there is a point where there is no change in elevation. This point is found first by determining the total change in elevation and by dividing that amount by the distance between the points; second, determine the change in elevation per foot of run.

Total change in elevation (C-D)  
 $= 0.3' + 0.7' = 1.0'$  change in elevation

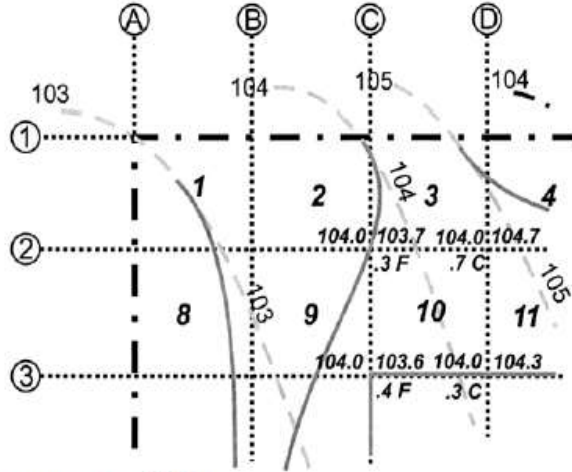

FIGURE 9.11. Grid 10.

Change in elevation per foot of run (C-D)  
 $= 1.0' / 50' = 0.02'$  per foot of run

Because the elevation change is 0.02 foot per foot of run, the estimator can determine how many feet must be moved along that line until there has been a 0.3-foot change in elevation.

Distance from C2 =  $0.3' / 0.02'$  per foot of run = 15'

This means that as one moves from point C2 toward point D2 at 15 feet past point C2, there is the theoretical point of no change in elevation, or the transition point between the cut and the fill. Because the same thing occurs along line 3 between points C3 and D3, the same calculations are required.

Total change in elevation (C-D)  
 $= 0.4' + 0.3' = 0.7'$  change in elevation

Change in elevation per foot of run (C-D)  
 $= 0.7' / 50' = 0.014'$  per foot of run

From this calculation, the distance from point C3 to the point of no change in elevation can be found.

Distance from C3 =  $0.4' / 0.014'$  per foot of run = 29'

Given this information, grid 10 can be divided into two distinct grids: one for cut and one for fill. Figure 9.12 details how the grid would be divided.

The next step is to determine the area of the cut and fill portions. A number of methods are available. Perhaps the most simple is to divide the areas into rectangles and/or triangles.

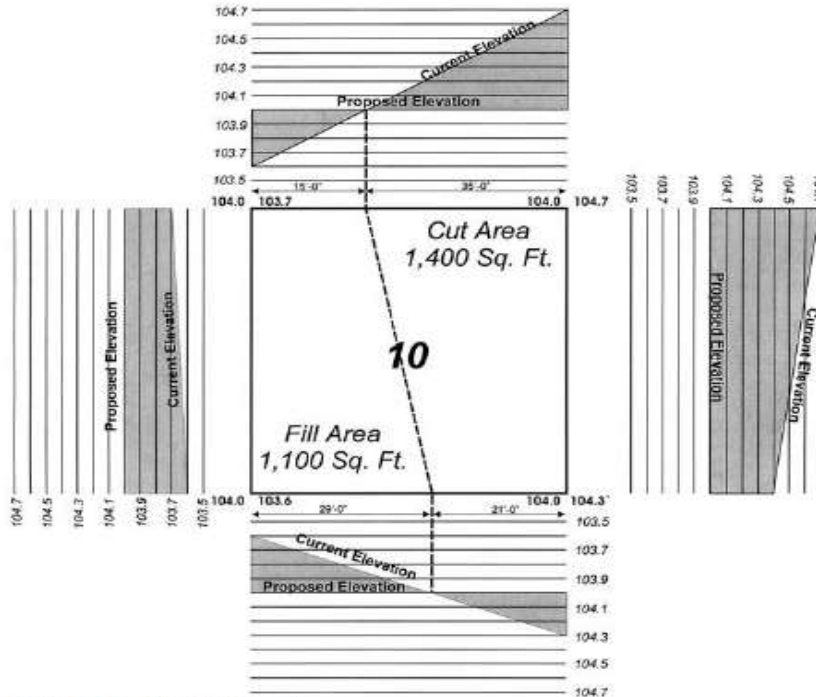

FIGURE 9.12. Grid 10 Layout.

Fill area<sub>Rectangle</sub> =  $15' \times 50' = 750$  sf  
 Fill area<sub>Triangle</sub> =  $0.5 \times 14' \times 50' = 350$  sf  
 Total fill area =  $750$  sf +  $350$  sf =  $1,100$  sf  
 Fill =  $\frac{0.3' + 0.4' + 0' + 0'}{4} \times 1,100$  sf =  $193$  ccf of fill

Cut area =  $2,500$  sf -  $1,100$  sf =  $1,400$  sf  
 Cut =  $\frac{0.3' + 0.7' + 0' + 0'}{4} \times 1,400$  sf =  $350$  bcf of cut

These cuts and fills are entered into the cut and fill columns on the cut and fill worksheet (Figure 9.16).

The area of the cut equals the area of the grid less the area of the fill.

**EXAMPLE 9-7 CUT AND FILL**

Occasionally when the grid is divided, a portion of the grid will be neither cut nor fill. Grid 3 is an example of such an occurrence. Figure 9.13 is an excerpt from the site plan. In that grid, the change from fill to cut occurs on line 2 between C and D.

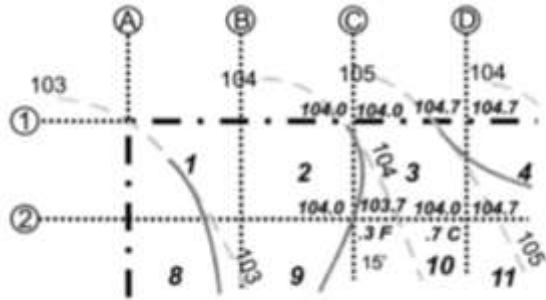

FIGURE 9.13. Grid 3.

Total change in elevation (C-D)

$$= 0.3' + 0.7' = 1.0' \text{ change in elevation}$$

Change in elevation per foot of run (C-D)

$$= 1.0' / 50' = 0.02' \text{ per foot of run}$$

From this calculation, the distance from point C2 to the point of no change in elevation can be found.

$$\text{Distance from C2} = 0.3' / 0.02' \text{ per foot of run} = 15'$$

$$\text{Fill area} = 0.5 \times 50' \times 15' = 375 \text{ sf}$$

$$\text{Cut area} = 0.5 \times 50' \times 35' = 875 \text{ sf}$$

$$\text{Fill} = \frac{0.3' + 0' + 0'}{3} \times 375 \text{ sf} = 38 \text{ ccf of fill}$$

$$\text{Cut} = \frac{0.7' + 0' + 0'}{3} \times 875 \text{ sf} = 204 \text{ bcf of cut}$$

Figure 9.14 shows the dimensions and proportions between cut, fill, and the unchanged area of grid 3. The remaining 1,250 sf theoretically have no cut or fill.

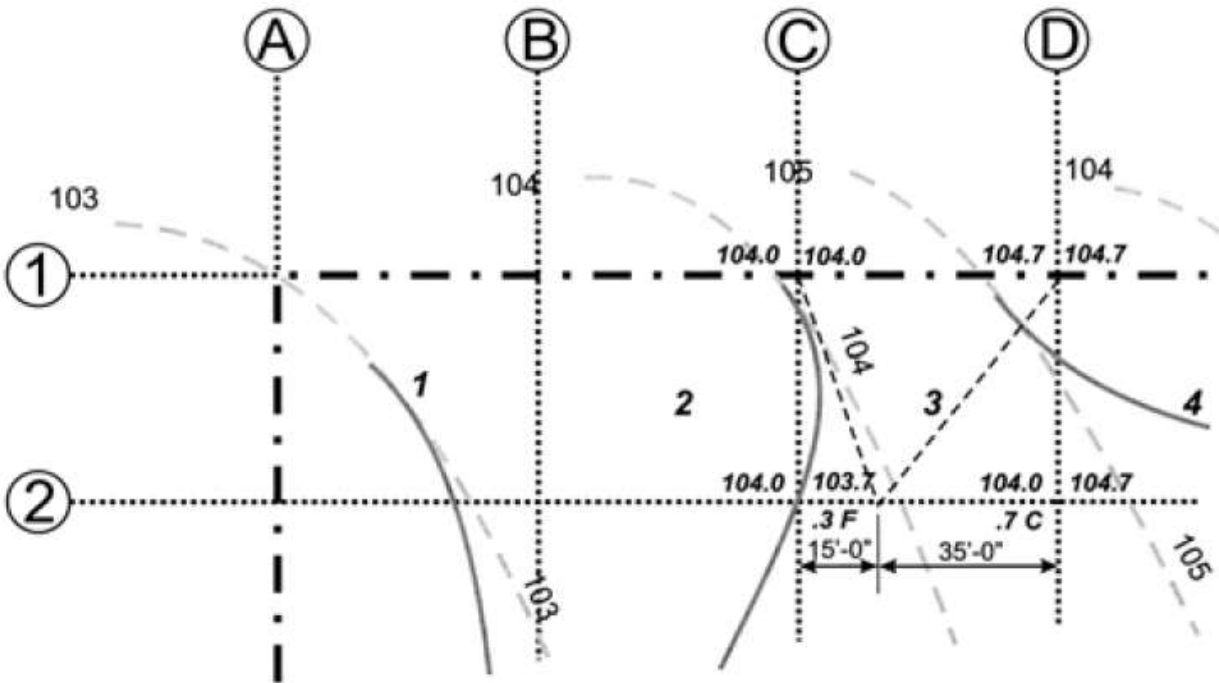

**FIGURE 9.14. Cut and Fill Area.**

Figure 9.15 is the entire site plan with the areas of no cut and fill shown. Figure 9.16 is the completed cut and fill worksheet for the entire plot.

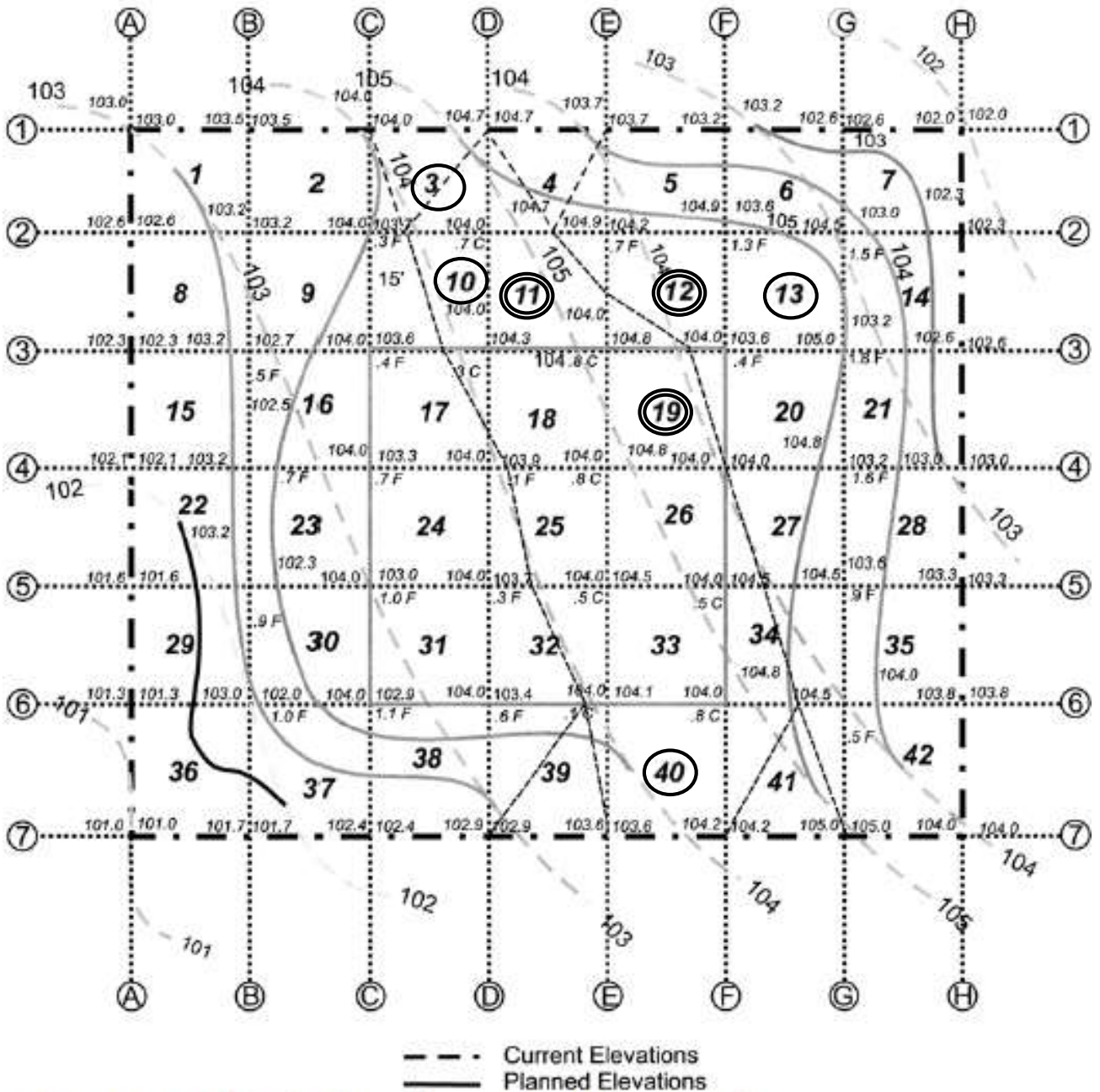

FIGURE 9.15. Complete Site Plan with Areas of No Change Noted.

ESTIMATE WORK SHEET																			
Project:	Little Office Building				Estimate No.	1234													
Location:	Littleville, TX				Sheet No.	1 of 1													
Architect:	U. R. Architects				Date	1/1/20XX													
Items:	Rough Grading				By	LHF				Checked	JBC								
Grid	Fill										Cut								
	Fill At Intersections					Points	Average	Area	Total	Cut At Intersections					Points	Average	Area	Total	
	1	2	3	4	5					1	2	3	4	5					
1						0	0		0						0	0		0	
2	0	0	0	0.3		4	0.075	2500	188						0	0		0	
3	0	0	0.3			3	0.1	375	38	0	0	0.7			3	0.233333	875	204	
4	0	0	0.7			3	0.233333	625	146	0	0	0.7			3	0.233333	625	146	
5	0.7	1.3	0	0		4	0.5	2500	1,250						0	0		0	
6	1.3	1.5	0	0		4	0.7	2500	1,750						0	0		0	
7	1.5	0	0	0		4	0.375	2500	938						0	0		0	
8	0	0.5	0	0		4	0.125	2500	313						0	0		0	
9	0.5	0.4	0	0.3		4	0.3	2500	750						0	0		0	
10	0.3	0	0.4	0		4	0.175	1100	193	0	0.7	0	0.3		4	0.25	1400	350	
11	0	0	0.7			3	0.233333	287.5	87	0.7	0	0	0.8	0.3	5	0.3	2212.5	664	
12	0	0.7	1.3	0.4	0	5	0.48	2054.5	986	0	0	0.8			3	0.266667	445.5	119	
13	1.3	1.5	0.4	1.8		4	1.25	2500	3,125						0	0		0	
14	1.5	0	1.8	0		4	0.825	2500	2,063						0	0		0	
15	0	0.7	0	0.5		4	0.3	2500	750						0	0		0	
16	0.5	0.4	0.7	0.3		4	0.475	2500	1,188						0	0		0	
17	0.4	0	0	0.1	0.3	5	0.1	2101	210	0	0.3	0			3	0.1	399	40	
18	0	0	0.1			3	0.033333	36	1	0	0	0.8	0.8	0.3	5	0.32	2464	788	
19	0	0.4	0			3	0.133333	425	57	0.8	0	0	0.8		4	0.4	2075	830	
20	0	1.6	0.4	1.8		4	0.95	2500	2,375						0	0		0	
21	1.6	0	1.8	0		4	0.85	2500	2,125						0	0		0	
22	0	0.9	0	0.7		4	0.4	2500	1,000						0	0		0	
23	0.7	0.3	0.9	1		4	0.725	2500	1,813						0	0		0	
24	1	0.3	0.7	0		4	0.5	2500	1,250						0	0		0	
25	0.1	0	0	0.3		4	0.1	625	63	0	0.8	0	0.5		4	0.325	1875	609	
26						0	0		0	0.8	0.5	0.5	0		4	0.45	2500	1,125	
27	0	1.6	0.9	0		4	0.625	2050	1,281	0	0.5	0			3	0.166667	450	75	
28	0.9	0	1.6	0		4	0.625	2500	1,563						0	0		0	
29	0	0.9	0	1		4	0.475	2500	1,188						0	0		0	
30	0.9	1	1	1.1		4	1	2500	2,500						0	0		0	
31	1.1	0.6	1	0.3		4	0.75	2500	1,875						0	0		0	
32	0.3	0	0.6	0		4	0.225	1550	349	0	0.5	0.1	0		4	0.15	950	143	
33						0	0		0	0.5	0.5	0.1	0.8		4	0.475	2500	1,188	
34	0	0.9	0	0.5		4	0.35	1275	446	0.5	0	0.8	0		4	0.325	1225	398	
35	0.9	0	0.5	0		4	0.35	2500	875						0	0		0	
36	0	0	0	1		4	0.25	2500	625						0	0		0	
37	1	1.1	0	0		4	0.525	2500	1,313						0	0		0	
38	1.1	0.6	0	0		4	0.425	2500	1,063						0	0		0	
39	0.6	0	0			3	0.2	1075	215	0.1	0	0			3	0.033333	175	8	
40						0	0		0	0.1	0.8	0	0		4	0.225	2500	963	
41	0.5	0	0			3	0.166667	475	79	0.8	0	0			3	0.266667	775	207	
42	0.5	0	0	0		4	0.125	2500	313						0	0		0	
															0	0		0	
TOTAL FILL - Compacted Cubic Feet									36,317	TOTAL CUT - Bank Cubic Feet									7,453
Compacted Cubic Yards									1,345	Bank Cubic Yards									278
Shrinkage Factor									0.95	Swell Factor									0.25
Required Bank Cubic Yards of Fill									1,416	Loose Cubic Yards of Cut to Haul									345
Net Bank Cubic Yards to Purchase									1,140										

FIGURE 9.16. Completed Cut and Fill Worksheet.

In the previous examples, it was assumed that the finish grade was the point at which the earthwork took place; however, this is typically not true. In Figure 9.17, the planned contour lines on the parking lot represent the top of the asphalt. Therefore, the rough grading will be at an elevation different from the one shown on the site plan. In this scenario, the elevation for the rough grading needs to be reduced by the thickness of the asphalt and base material.

## Cut and Fill with Paving

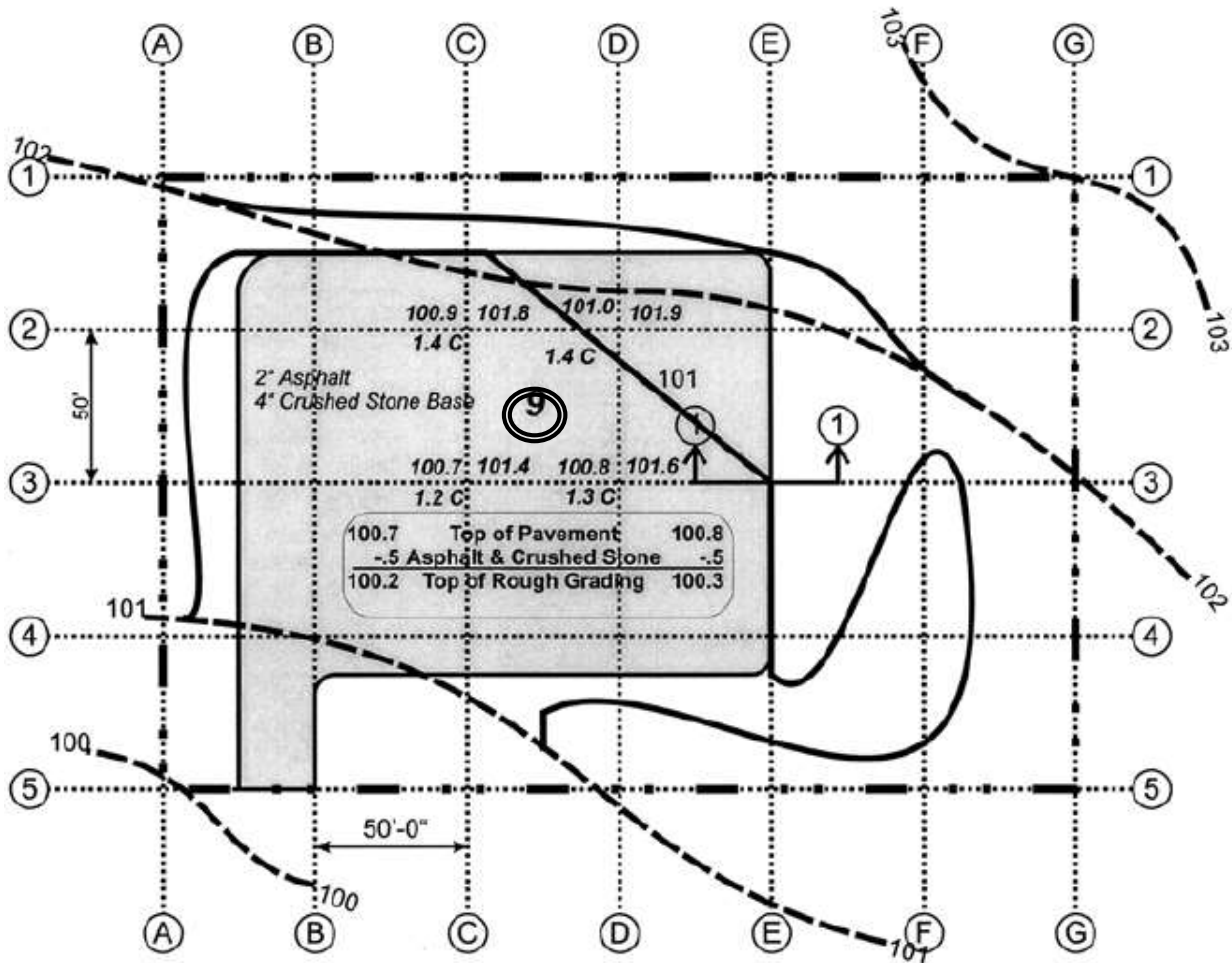

FIGURE 9.17. Parking Lot Site Plan.

### EXAMPLE 9-8 CUT AND FILL WITH PAVING

Using Figures 9.17 and 9.18, determine cut for grid 9. In Figure 9.18, the top of the rough grade is 0.50 foot below the top of pavement. The cuts are the differences between the existing elevation and the top of the rough grade, and are shown in Figure 9.19.

$$\text{Cut} = \frac{1.4' + 1.4' + 1.2' + 1.3'}{4} \times 2,500 \text{ sf}$$

$$= 3,313 \text{ bcf or } 123 \text{ bcy}$$

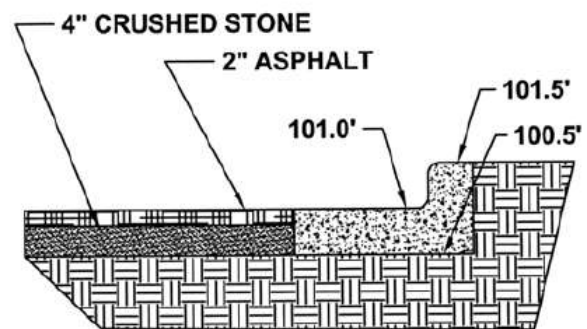

FIGURE 9.18. Cross-Section Through Pavement.

Point	Top of Pavement	Top of Rough Grade	Existing Elevation	Cut (ft.)
C2	100.9'	100.4'	101.8'	1.4'
D2	101.0'	100.5'	101.9'	1.4'
C3	100.7'	100.2'	101.4'	1.2'
D3	100.8'	100.3'	101.6'	1.3'

FIGURE 9.19. Data for Grid 9.

### Simple Grid Method

When a project site is divided with a grid of equal squares or rectangles, and all the grid intersections require only cut or only fill, then we can use the following method.

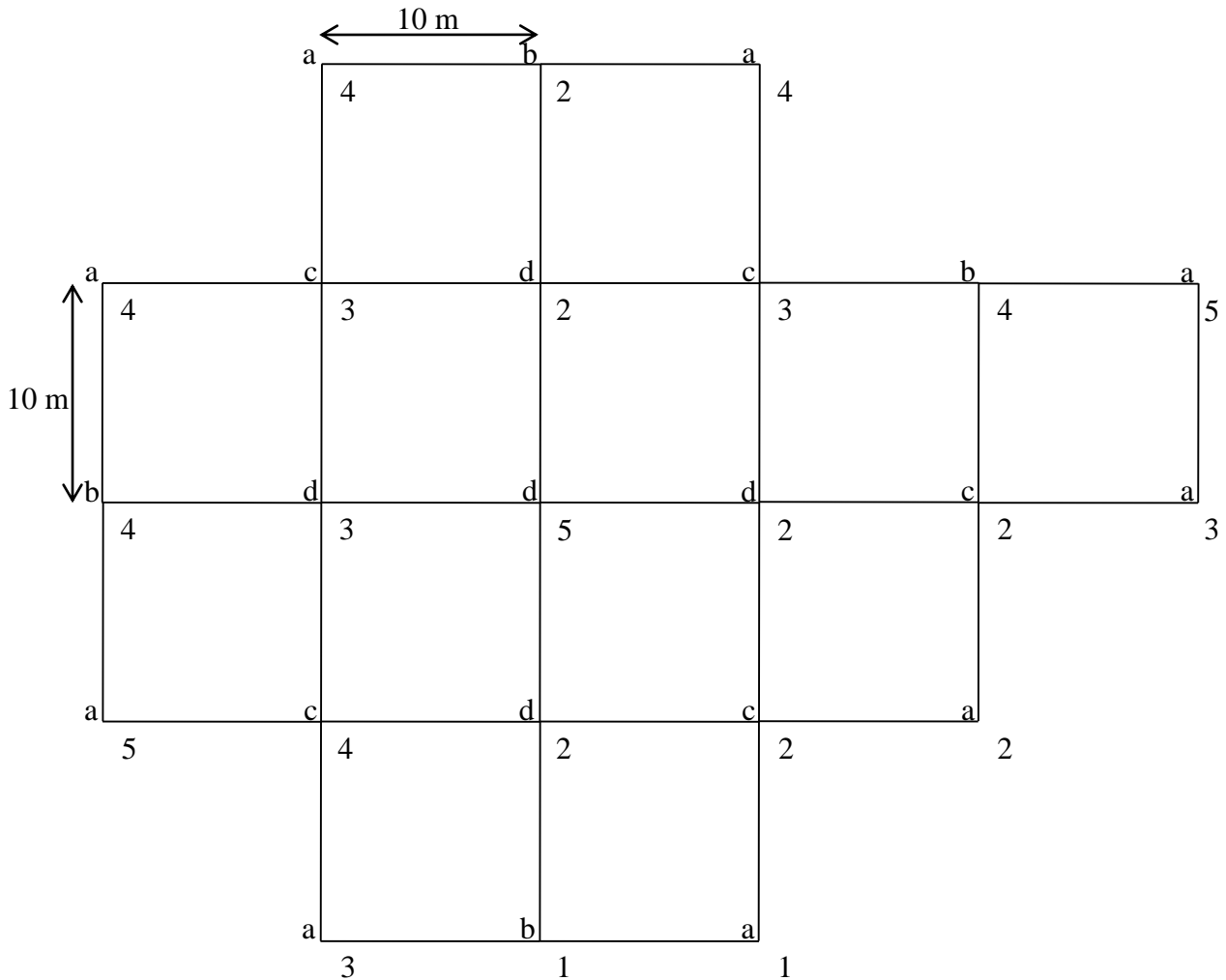

The volume of cutting or filling is calculated as follows:

$$Volume = \frac{\text{Area of one rectangle}}{4} \times (a + 2b + 3c + 4d)$$

$$a = 4 + 4 + 4 + 5 + 3 + 5 + 2 + 3 + 1 = 31$$

$$b = 2 + 4 + 4 + 1 = 11$$

$$c = 3 + 3 + 2 + 4 + 2 = 14$$

$$d = 2 + 3 + 5 + 2 + 2 = 14$$

$$Volume = \frac{10 \times 10}{4} \times (31 + 2 \times 11 + 3 \times 14 + 4 \times 14) = 3775 \text{ m}^3$$

## 2.4 General Excavation

Included under general (mass) excavation is the removal of all types of soil that can be handled in fairly large quantities, such as excavations required for a basement, mat footing, or a cut for a highway or parking area.

To determine the amount of general excavation, it is necessary to determine the following:

1. Building dimensions.
2. The distance of footings beyond the project wall.
3. The amount of working space required between the edge of the footing and the beginning of excavation.
4. The elevation of the existing land, by checking the existing contour lines on the site plan.
5. The type of soil that will be encountered.
6. Whether the excavation will be sloped or supported.
7. The depth of the excavation.

Material	Angle		
	Wet	Moist	Dry
Gravel	15-25	20-30	24-40
Clay	15-25	25-40	40-60
Sand	20-35	35-50	25-40

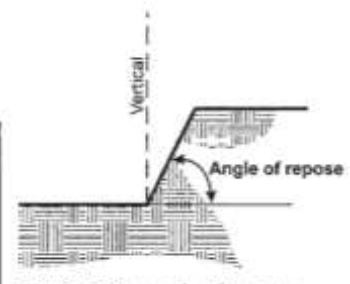

FIGURE 9.29. Earthwork Slopes.

FIGURE 9.28. Angle of Repose.

If job conditions will not allow the sloping of soil, the estimator will have to consider using sheet piling or some type of bracing to shore up the bank.

When sloping sides are used for mass excavations, the volume of the earth that is removed is found by developing the average cut length in both dimensions and by multiplying them by the depth of the cut.

### Basement Excavation

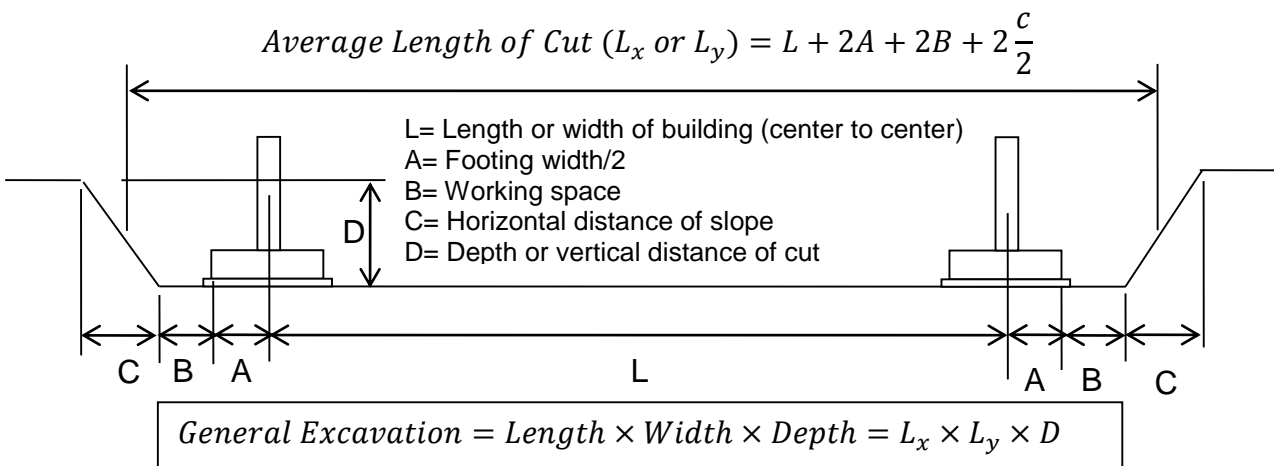

### Example:

Determine the amount of general excavation required for the basement portion of the building shown in the following figure. Assume the workspace between the edge of the footing and the beginning of the excavation will be 0.5 m, by checking the existing contour lines on the site plan the expected depth of the cut is 3 m after a deduction for the topsoil that would have already been removed, and a slope of 2:1 for soil will be used, which means for every 2 m of vertical depth an additional 1 m of horizontal width is needed, rather than using shoring or sheet piling.

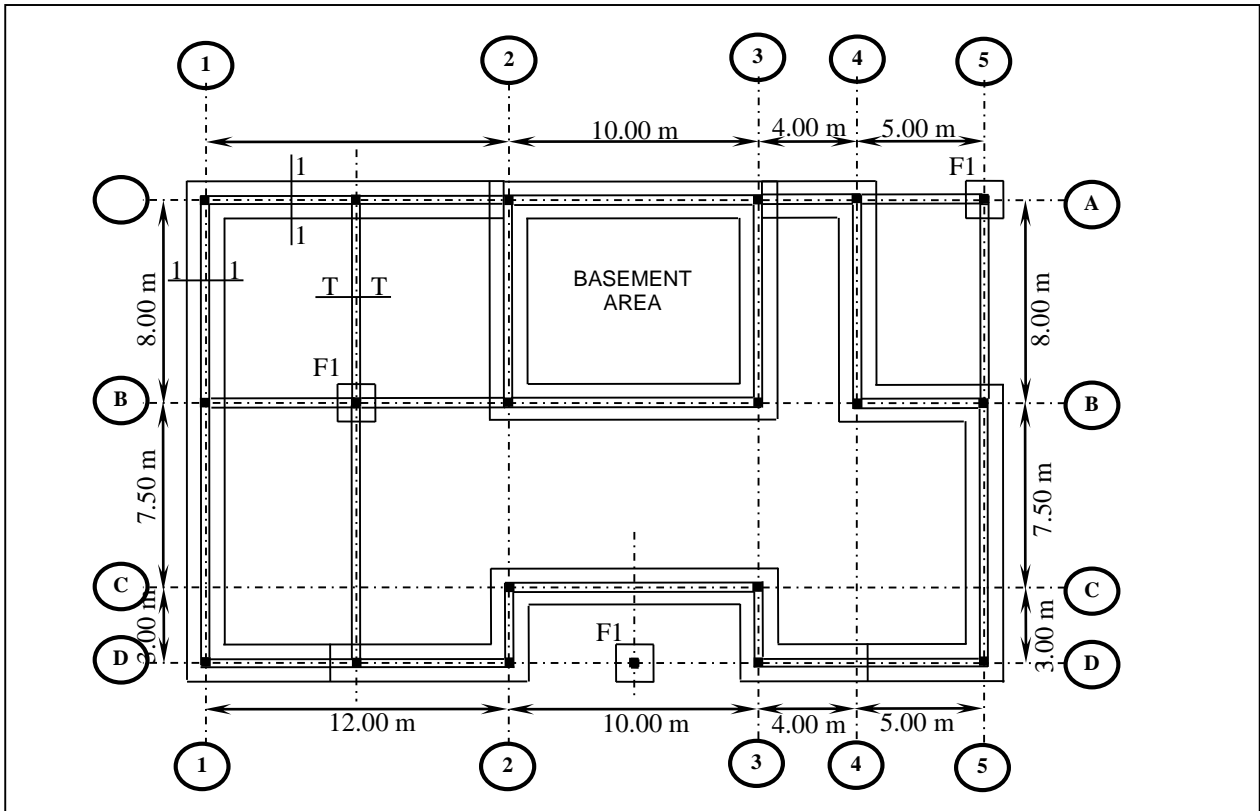
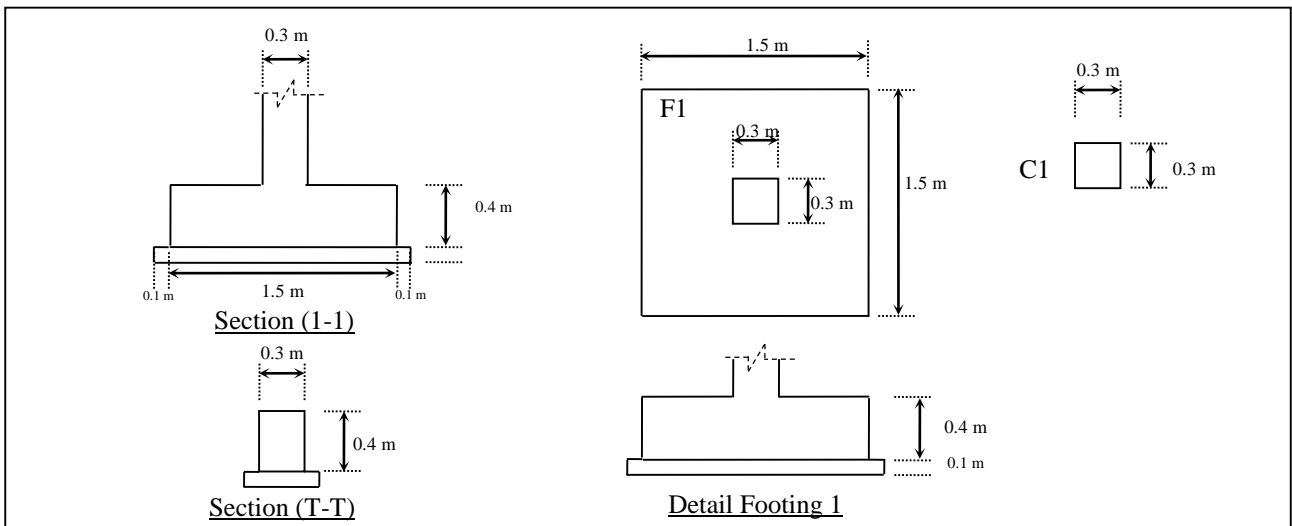

Figure 9.32. Building Plan.



Cross-Sections of Footings

**Solution:**



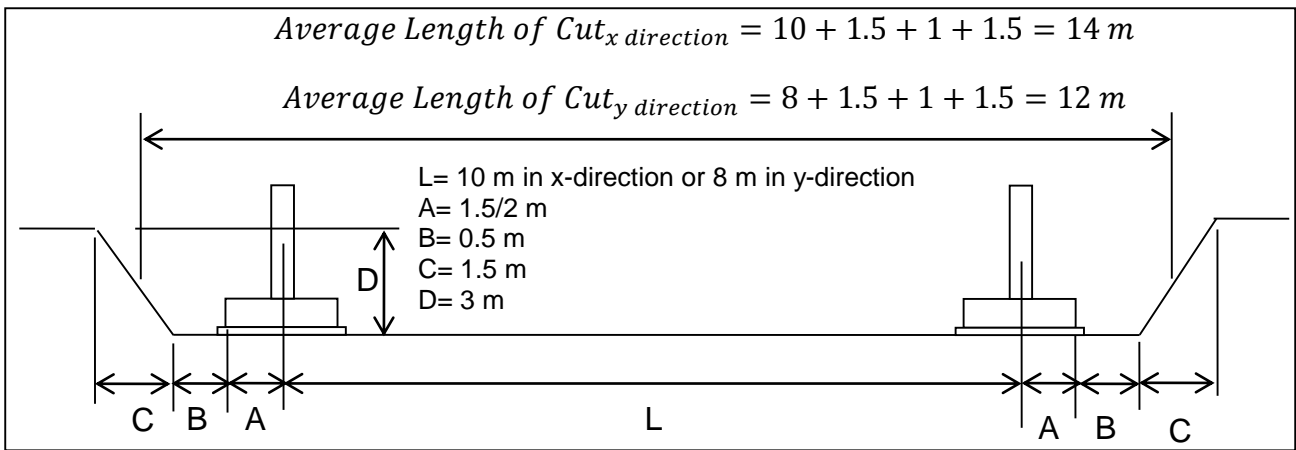

Figure 9.33. Basement Cross-Section

General Excavation = Length × Width × Depth

General Excavation = 14 × 12 × 3 = 504 m<sup>3</sup>

**Continuous Footing Excavation**

**Example:**

Determine the amount of general excavation required for the continuous footings of the building shown in the building plan and the cross-sections drawings. Assume that the slope of the soil will be 1.5:1, the working area will be 0.5 m, and the depth of excavation will be 1.5 m.

**Solution:**

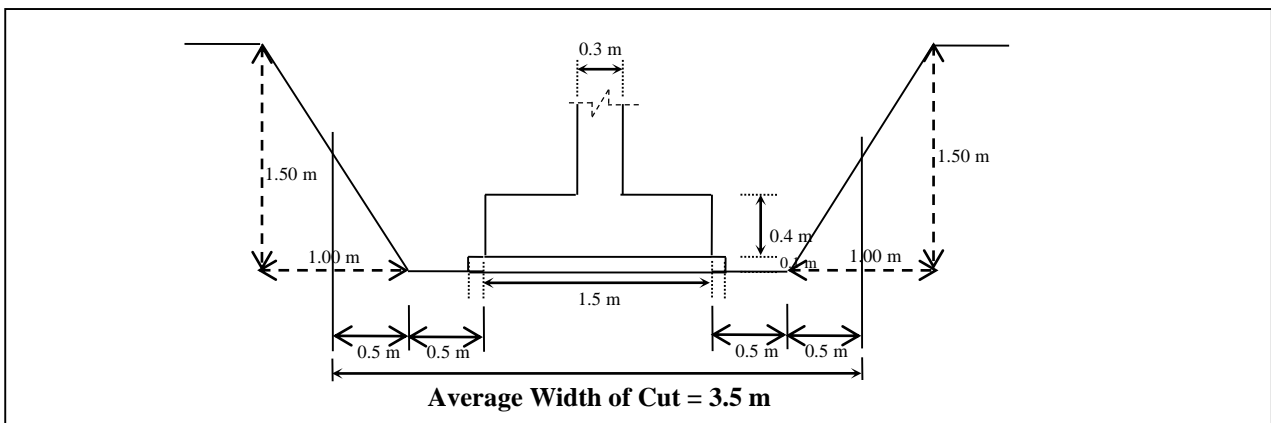

Width of Cut = 3.5 m

Depth of Cut = 1.5 m

Length of Cut = A1toA2 + A3toA4 + A4toB4 + B4toB5 + B5toD5 + D5toD3 + D3toC3 + C3toC2 + C2toD2 + D2toD1 + D1toA1 – Width of cut already calculated in the basement excavation

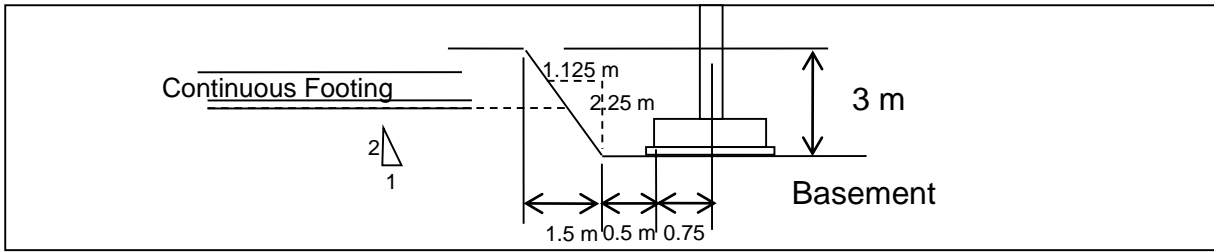

$$\text{Length of Cut} = 12+4+8+5+7.5+3+5+4+3+10+3+12+3+7.5+8 - 2 \times (0.75+0.5+0.75)$$

$$= 91 \text{ m}$$

*Volume of Continuous Footing Excavation = Length × Width × Depth*

$$\text{Excavation} = 91 \times 3.5 \times 1.5 = 465.9 \text{ m}^3$$

### *Spread Footing Excavation*

#### **Example:**

There are 3 spread footings shown in building figure. Given that the soil slope should be 1.5:1, the working distance should be 0.5 m, the cut depth will be 1.5 m, and the footing is square. Calculate the excavation volume?

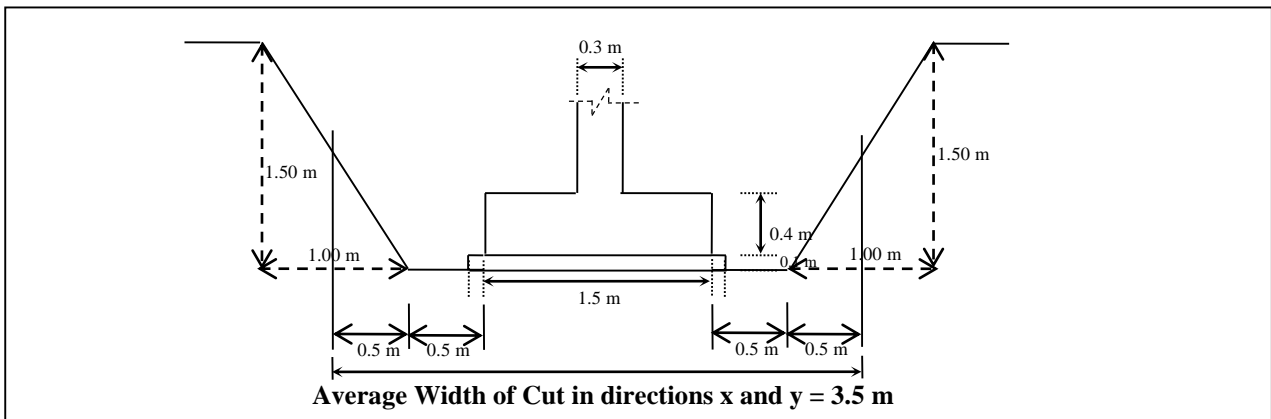

*Volume of Spread Footings (F1) Excavation = Length × Width × Depth × Number*

$$\text{Excavation} = 3.5 \times 3.5 \times 1.5 \times 3 = 55.125 \text{ m}^3$$

## 2.5 Backfilling (أعمال الردم)

### Backfilling the Basement Walls

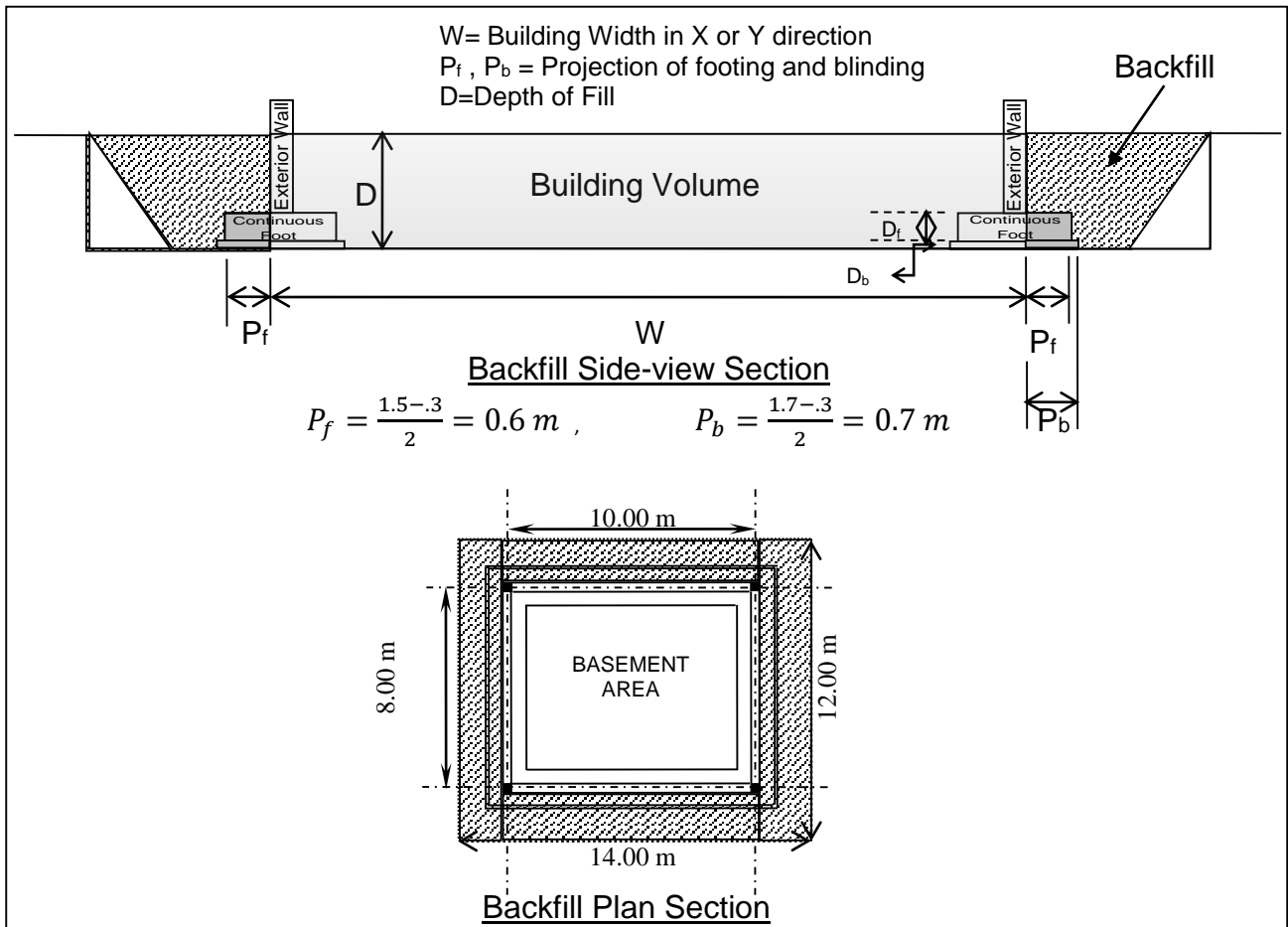

$$\text{Basement Total Excavation} = 14 \times 12 \times 3 = 504 \text{ m}^3$$

$$\text{Basement Building Volume} = 10.3 \times 8.3 \times 3 = 256.47 \text{ m}^3$$

$$\text{Footing and Blinding Projection Volume} = P_f \times D_f \times L_f + P_b \times D_b \times L_b$$

$$\text{Footing and Blinding Projection Volume}$$

$$= 0.6 \times 0.4 \times (10.9 \times 2 + 8.9 \times 2) + 0.7 \times 0.1 \times (11 \times 2 + 9 \times 2) = 12.3 \text{ m}^3$$

$$\text{Basement Total Fill} = \text{Total Excavation} - \text{Building Volume} - \text{Footing Volume}$$

$$= 504 - 256.47 - 12.3 = 235.23 \text{ m}^3$$

## Backfilling the Continuous Foundations

There are two ways in which the quantity of backfill can be determined. Both will yield virtually the same answer. The first is to subtract the area of the footing from the area backfill and multiply that number by the length of the footing. Alternately, the area of backfill can be calculated by figuring the area of backfill and multiplying that amount by the length.

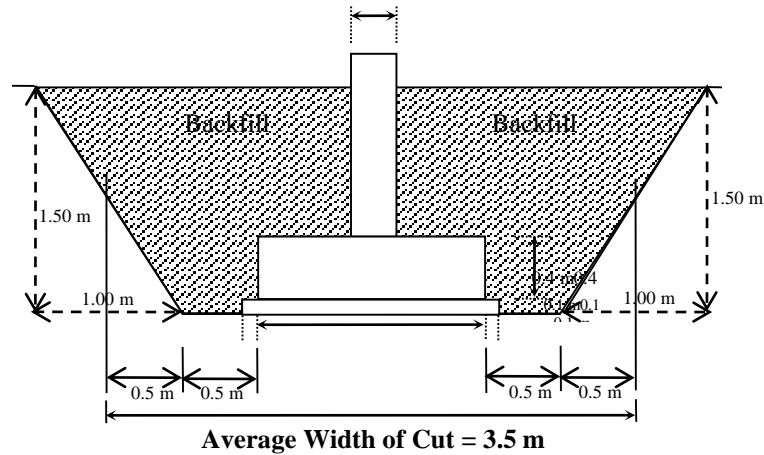

### Method 1

$$\begin{aligned} \text{Volume of Continuous Footing Cut} &= 3.5 \times 1.5 \times 88.75 = 465.9375\text{m}^3 \\ \text{Volume of Concrete} &= \text{Blinding Volume} + \text{Footing Volume} + \text{Wall Volume} \\ &= 1.7 \times 0.1 \times 88.75 + 1.5 \times 0.4 \times 88.75 + 0.3 \times 1.0 \times 88.75 = 94.9625\text{m}^3 \\ \text{Volume of Backfill} &= \text{Cut Volume} - \text{Concrete Volume} \\ \text{Volume of Backfill} &= 465.9375 - 94.9625 = 370.975\text{m}^3 \end{aligned}$$

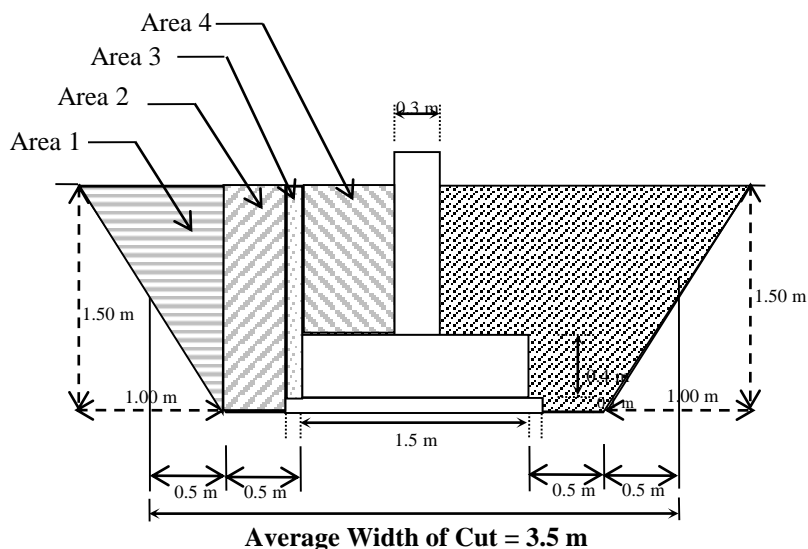

### Method 2

$$\begin{aligned} \text{Volume of Backfill} &= 2 \times (\text{Area 1} + \text{Area 2} + \text{Area 3} + \text{Area 4}) \times \text{Length of Cut} \\ \text{Volume of Backfill} &= 2 \times (0.5 \times 1 \times 1.5 + 0.4 \times 1.5 + 0.1 \times 1.4 + 0.6 \times 1) \times 88.75 = 370.975\text{m}^3 \end{aligned}$$

Keep in mind that the material being brought in is loose and will be compacted on the job. If it is calculated that  $100 \text{ m}^3$  are required, the contractor will have to haul in at least 110 to  $140 \text{ m}^3$  of soil—even more if it is clay or loam.

**EXAMPLE 9-13 EQUIPMENT AND LABOR COST**

Equipment selection for the removal of topsoil will probably be limited to either a bulldozer or a front-end loader. Assume that a 1-cy bucket front-end loader is selected (see Figures 9.26 and 9.27) and its production rate is estimated to be an average of 24 bcy per hour. Mobilization time is estimated at 2.5 hours, the operating cost per hour for the equipment is estimated at \$11.35, and the cost for an operator is \$17.75 per hour. Estimate the number of hours and the cost to strip the topsoil.

First, the total hours required to complete the topsoil removal (Example 9-12) must be calculated. Divide the total cubic yards to be excavated by the rate of work done per hour, and add the mobilization time; the answer is the total hours for this phase of work.

$$\text{Hours} = \frac{214 \text{ bcy}}{24 \text{ bcy per hour}} + 2.5 \text{ hours} = 11.4 \text{ hours}$$

The total number of hours is then multiplied by the cost of operating the equipment per hour, plus the cost of the crew for the period of time.

$$\text{Equipment cost} = \$11.35 \text{ per hour} \times 11.4 \text{ hours} = \$129$$

$$\text{Lobor cost} = \$17.75 \text{ per hour} \times 11.4 \text{ hours} = \$202$$

$$\text{Total cost} = \$129 + \$202 = \$331$$

Soil	Dozer				Tractor shovel		Front end loader		Backhoe	
	50' haul		100' haul		No haul		50' haul	100' haul	No haul	
	50 hp	120 hp	50 hp	120 hp	1 c.y..	2.25 c.y.	1 c.y.	2.25 c.y..	.5 c.y..	1 c.y..
Medium	40	100	30	75	40	70	24	30	25	55
Soft, sand	45	110	35	85	45	90	30	40	25	60
Heavy soil or stiff clay	15-20	40	10-15	30-35	15-20	35	10	12	10	15

FIGURE 9.26. Equipment Capacity (cy per Hour).

Load and haul		
Truck size	Haul	c.y.
6 c.y.	1 mile	12-16
6 c.y.	2 miles	8-12
12 c.y.	1 mile	18-22
12 c.y.	2 miles	12-14

FIGURE 9.27. Truck Haul (cy per Hour).

## 2.6 Concrete Works (أعمال الخرسانة)

The concrete for a project may be either ready mixed or mixed on the job.

When estimating footings, columns, beams, and slabs, their volume is determined by taking the linear dimension of each item times its cross-sectional area.

The procedure that should be used to estimate the concrete on a project is as follows:

1. Review the specifications to determine the requirements for each area in which concrete is used separately (such as footings, floor slabs, and walkways) and list the following:

- Type of concrete
- Strength of concrete
- Color of concrete
- Any special curing or testing

2. Review the drawings to be certain that all concrete items shown on the drawings are covered in the specifications.

3. List each of the concrete items required on the project.

4. Determine the quantities required from the **working drawings**. Footing sizes are checked on the wall sections and foundation plans. Watch for different size footings under different walls.

### Jordanian Specifications

تكال أعمال الخرسانة المصبوبة في الموقع بجميع أنواعها كيلا هندسيا بالمتر المكعب لواقع الأعمال التي تم تنفيذها فعلا بعد حسم جميع الفراغات والفتحات والشفرات التي يزيد حجمها عن ( ٠.٥ ر.٥ ) مترا مكعبا بدون حسم حجم مواد التسليح المدفونة في الخرسانة، وحسب القواعد التالية :-

- \* لا تكال أعمال الخرسانة الزائدة عن المساحات أو الأحجام أو المقاطع المنصوص عليها في المواصفات الخاصة .
- \* تكال الجدران الأرضية ابتداء من تقط التقائها بالأعمدة .
- \* تكال الأعمدة والجدران ابتداء من ظهر الأساسات أو القواعد وحتى نقطة التقائها مع الجدران أو العقدات .
- \* تكال خرسانة الأدرج وبسطاتها بحيث تشمل خرسانة الأدرج والبسطات ضمن الجدران أو الأعمدة المركزة عليها ( إن وجدت ) كما تكال خرسانة البسطات أو الجدران الحاملة للأدرج والتي تشكل جزءا من العقدات .
- \* تكال خرسانة العقدات والجدران والأدرج والبسطات المركزة على الجدران الحجرية بحيث يشمل الكيل نصف سماكة تلك الجدران الحجرية .
- \* تكال خرسانة العناصر الانشائية المنفصلة ابتداء من نقط ابتداء التقائها بالجدران أو الأعمدة أو الأساسات باستثناء حالات الالتقاء بالجدران الحجرية، حيث يكال معها نصف سماكة تلك الجدران الحجرية .
- \* خرسانة النظافة تحت الأساسات : تكال بالمتر المربع للسماكة المحددة في جدول الكميات بعد حسم الفراغات والفتحات والشفرات التي تزيد مساحتها عن ( ٠.١ ) مترا مربعا .

طوب العقدات الخرسانية :

تكال أعمال طوب العقدات الخرسانية بالعدد للوحدة المحددة المقاسات والتفاصيل لواقع الأعمال التي تم تنفيذها فعلا ويعتبر جزء الطوبة لأغراض الكيل طوبة كاملة .

أعمال التسليح :

( أ ) تكال أعمال التسليح بالطن لواقع الأعمال التي تم تنفيذها فعلا وحسب المخططات التفصيلية والجدول التفصيلية للفصص والتي. ويشمل الكيل العقدات والوصلات المنصوص عليها في المواصفات الخاصة أو المينة على المخططات .

تكال الأرضيات الخرسانية كيلا هندسيا بالمتر المربع لواقع المساحات التي تم صبها فعلا من وجه الجدار الى الوجه المقابل، بحيث تخصم الفتحات التي تزيد مساحتها عن ( ٥٠ ) مترا مربعا. ويكون السعر شاملا لكل ما يلزم من مواد ومصنعية كتجهيز الأرضيات وصبها وإيناعها وتنعيم السطح، وقص الفواصل وتجهيزها وتعبئتها بالمواد المختامة اذا ورد نص صريح بذلك في جدول الكميات على ان تبين المخططات المعلومات والتفاصيل الكاملة المطلوبة للفواصل من حيث الأطوال والمقاسات وأماكن وجودها في الأرضيات الخرسانية، وغير ذلك مما يلزم لانجاز الاعمال على أكمل وجه حسبما ورد في هذه المواصفات .

**Examples**

Use the following building plan and cross-sections to calculate the concrete contained in the following items:

- a. Blinding (صبية النظافة)
- b. Continuous and Spread Footings (الأساسات المستمرة و المنفصلة), and Grade Beams (الجسور الأرضية)
- c. Retaining and Bearing Walls (الجدران الإستنادية و الحاملة), and Columns (الأعمدة)
- d. Basement and Ground Floorings (المعدات الأرضية)
- e. Staircases (الأدراج)
- f. Solid and Ribbed Slabs (العقدات المصمتة أو عقدات الأعصاب)

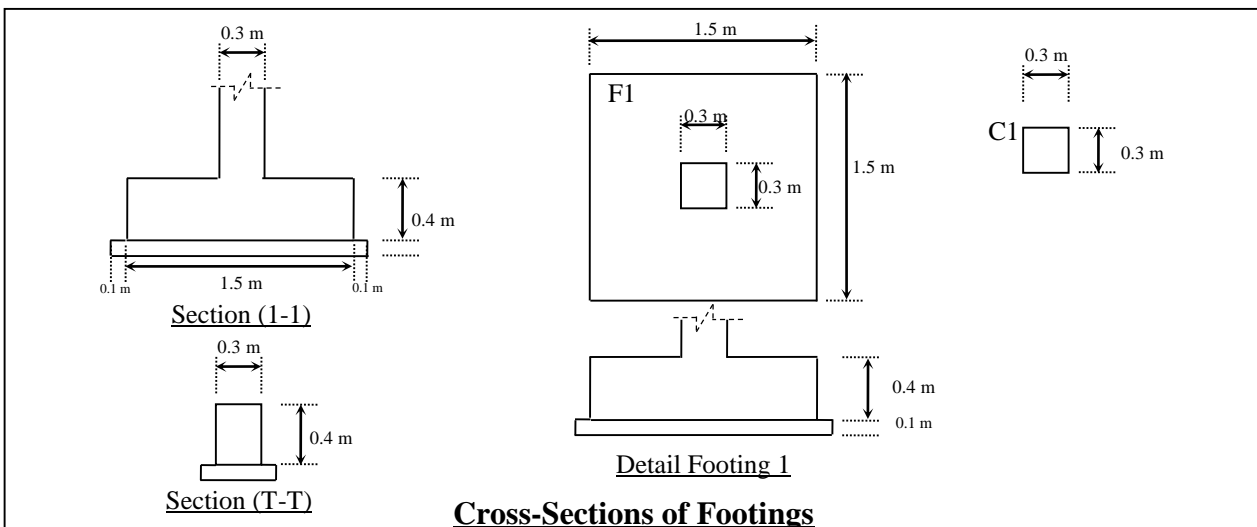
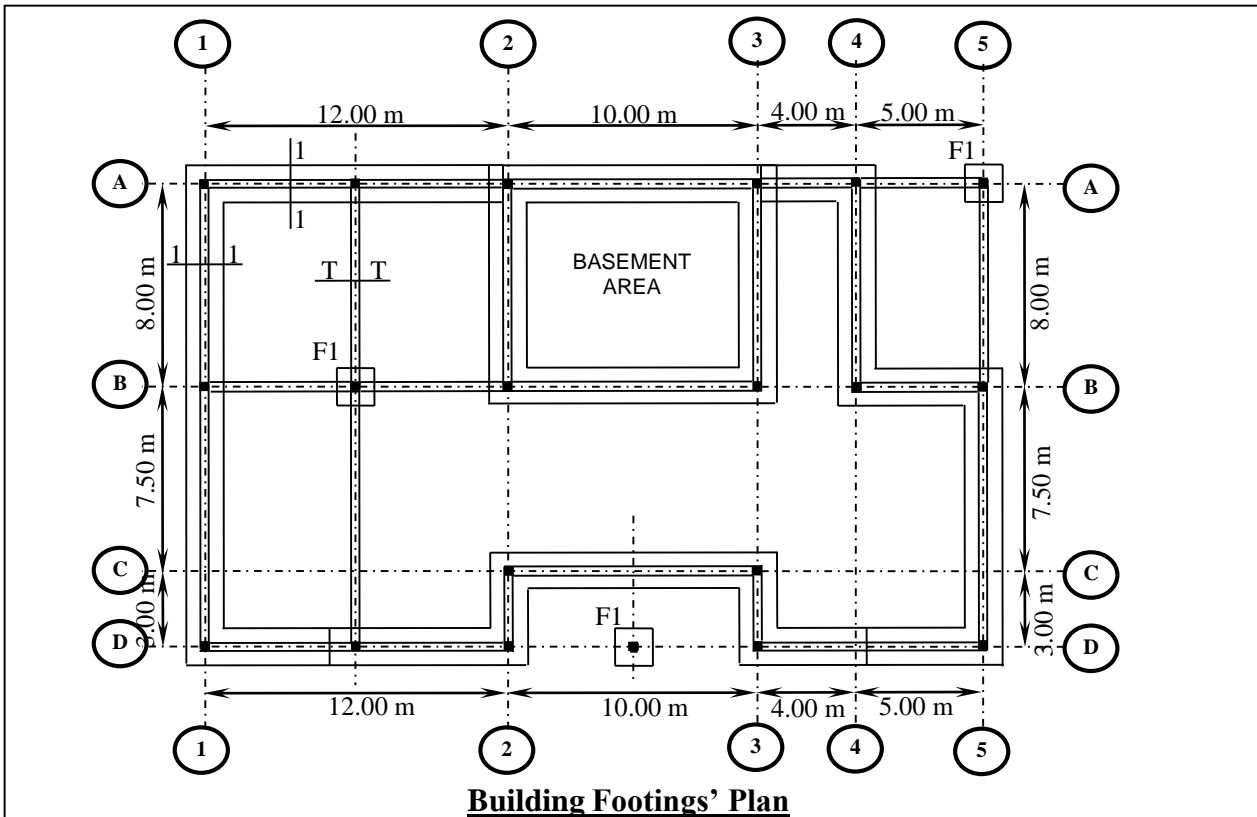

### 2.6.1 Blinding (خرسانة النظافة)

Measured in m<sup>2</sup>

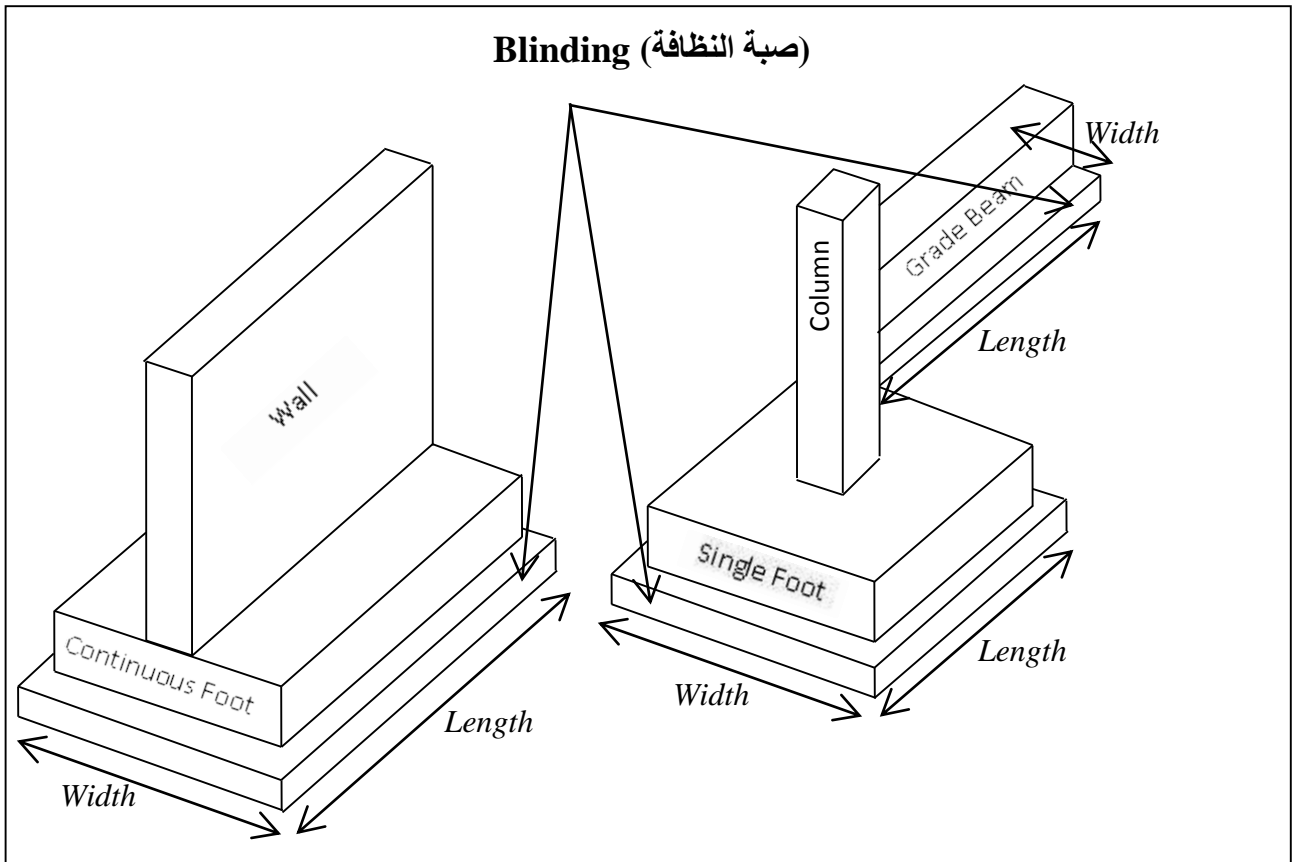

$$\text{Blinding of continuous Footing (1 - 1)} = \text{Width} \times \text{Length}$$

$$= 1.7 \times (12 + 10 + 4 + 8 + 5 + 7.5 + 3 + 5 + 4 + 3 + 10 + 3 + 12 + 18.5 + 8 + 10 + 8 - 1.7)$$

$$= 219.81 \text{ m}^2$$

$$\text{Blinding of Single Footings (F}_1) = \text{Width} \times \text{Length} \times \text{Number}$$

$$= 1.7 \times 1.7 \times 3 = 8.67 \text{ m}^2$$

$$\text{Blinding of Grade Beam (T - T)} = \text{Width} \times \text{Length}$$

$$= 0.5 \times (7.7 + 10.2 + 11.4 + 4.7 + 7.7) = 20.85 \text{ m}^2$$

$$\text{Total Blinding Area} = 219.81 + 8.67 + 20.85 = 249.33 \text{ m}^2$$



## 2.6.2 Concrete of Footings (خرسانة الأساسات)

Measured in  $m^3$

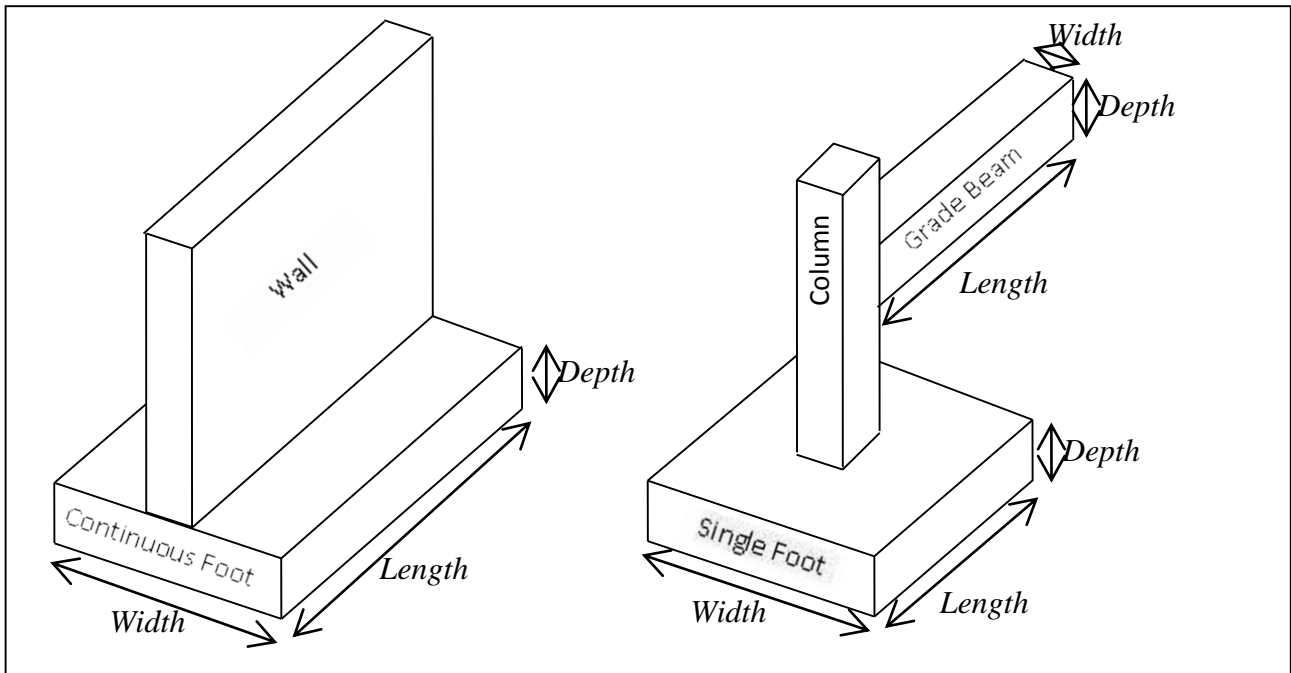

*Continuous Footing* (1 – 1) =  $Width \times Depth \times Length$

$$= 1.5 \times 0.4 \times (12 + 10 + 4 + 8 + 5 + 7.5 + 3 + 5 + 4 + 3 + 10 + 3 + 12 + 18.5 + 8 + 10 + 8 - 1.5)$$

$$= 78.42 \text{ m}^3$$

If step footing is used, then add

$$= 1.5 \times 0.4 \times (\text{Difference of excavation elevations between the ground floor and basement floor}) \times 2$$

*Single Footing* (F1) =  $Width \times Depth \times Length \times Number$

$$= 1.5 \times 0.4 \times 1.5 \times 3 = \text{m}^3$$

*Grade Beam* (T – T) =  $Width \times Depth \times Length$

$$= 0.3 \times 0.4 \times (7.7 + 10.2 + 5.7 + 5.7 + 4.7 + 7.7) = \text{m}^3$$

\*When ordering concrete to the project site, add 5% to the calculated volumes for waste and round off.

**Concrete of Walls and Columns: (خرسانة الجدران و الأعمدة) Measured in m<sup>3</sup>**

- a. Retaining Walls of the Basement
- b. Bearing Walls outside the Basement
- c. Shear Walls of the Staircases
- d. Columns

**Concrete of Floors: (خرسانة المدات الأرضية) Measured in m<sup>2</sup>**

**Concrete of Stairs: (خرسانة الأدرج) Measured in m<sup>3</sup>**

2.6.3 Concrete of Slabs (خرسانة العفدات)

Measured in m<sup>3</sup>

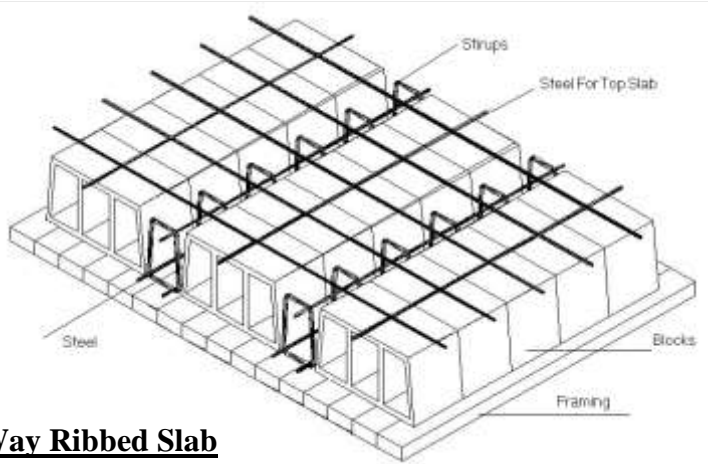

**One Way Ribbed Slab**

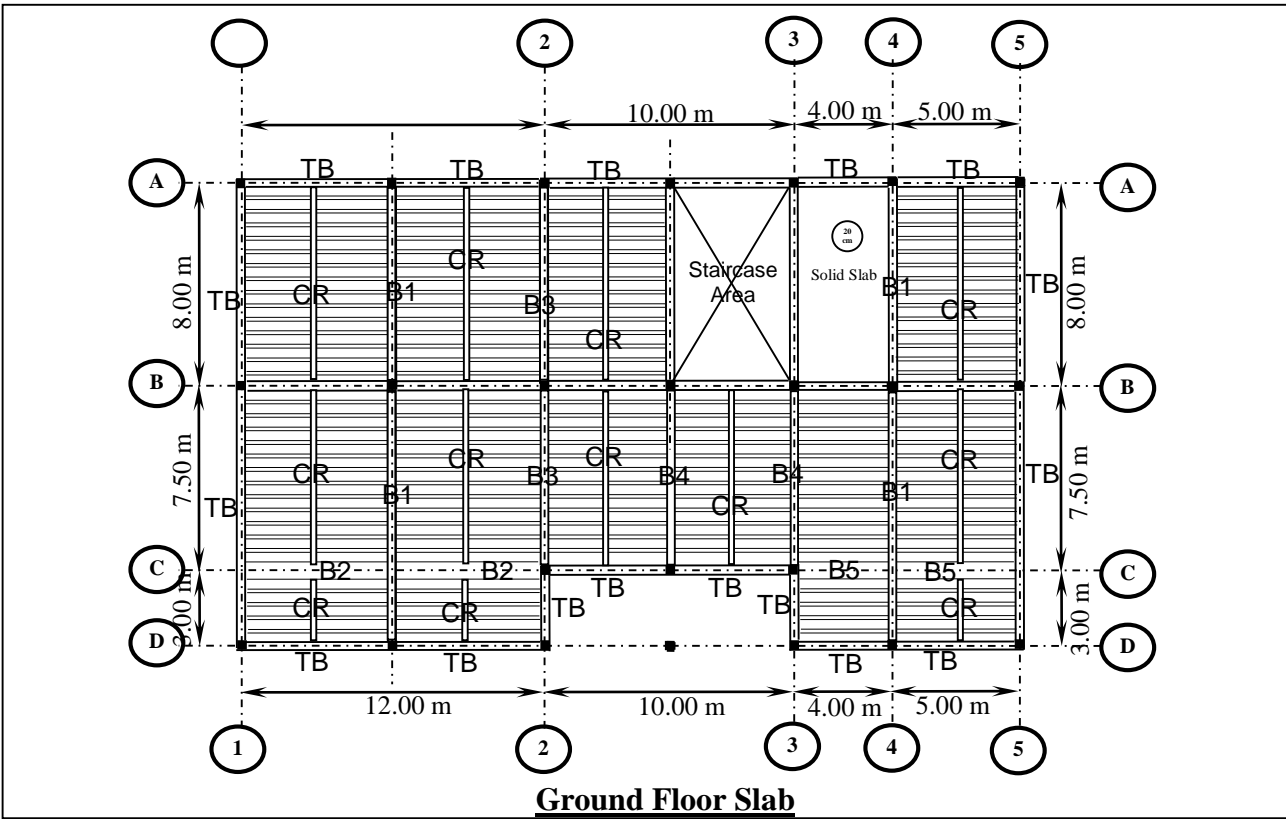

**Ground Floor Slab**

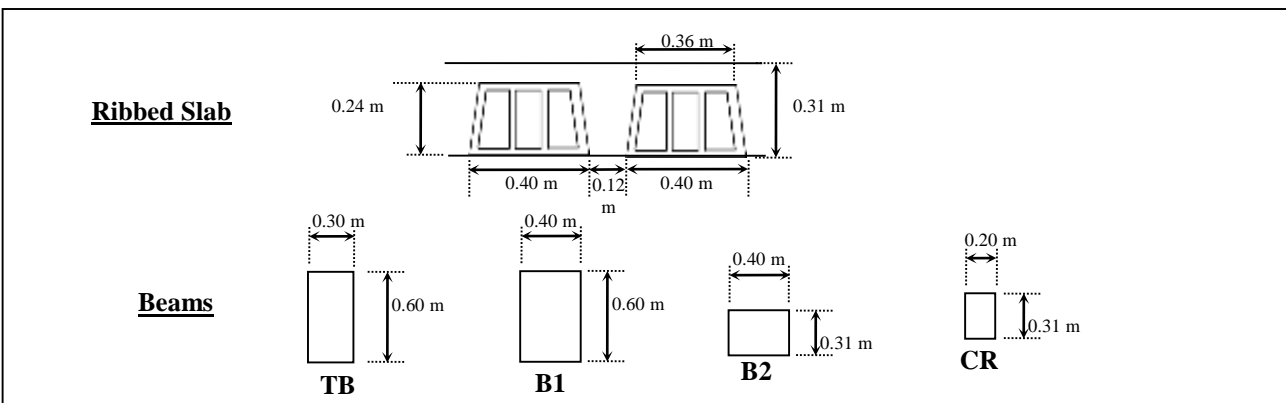

Find concrete volume for the following types of slabs:

(A) Solid Slab. (B) One-way Ribbed Slab

Item	Work Description	Unit	Dimensions			No.	Total Quantity	Notes
			Length	Width	Height			
1	Solid Slab	m <sup>3</sup>	4.4	3.7	0.20	1	3.256	Basement Slab (A)
2	One-way Ribbed Slab	m <sup>3</sup>	1.3	10	0.31			
			7.4	13.7	0.31			
			5.9	9.9	0.31			
			2.1	5.9	0.31		57.406	
	Reduce bricks volume					38x18		(B)
						16x13		(C)
						15x17		(D)
						7x10		(E)
	Total volume of Bricks=	No.	0.2	0.38	0.24	1217	-22.198	B,C,D, and E
	Total Concrete Volume=	m <sup>3</sup>					35.208	

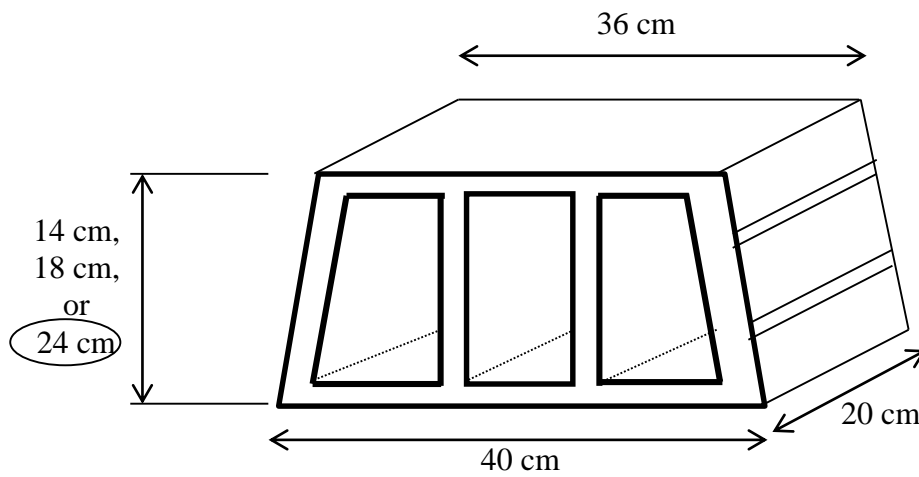

**Slab Block Dimensions**



## 2.7 Steel Reinforcement (أعمال حديد التسليح)

The reinforcing used in concrete may be reinforcing bars, welded wire mesh (WWF), or a combination of the two.

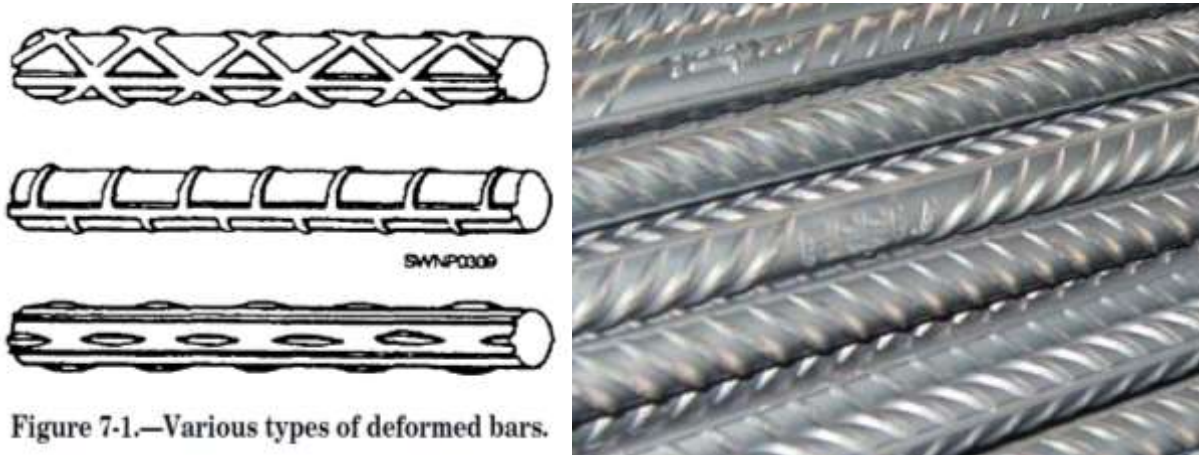

Figure 7-1.—Various types of deformed bars.

Size (mm)	6	8	10	12	14	16	18	20
Area (mm <sup>2</sup> )	28.3	50.3	78.5	113.0	153.96	201.0	254.0	314.0
Weight (kg per m)	0.222	0.395	0.617	0.888	1.209	1.58	<b>2.00</b>	2.47

Size (mm)	22	25	28	32	36	40	45	50
Area (mm <sup>2</sup> )	381.0	491.0	616.0	804.0	1020.0	1257.0	1509.0	1963.0
Weight (kg per m)	2.98	3.85	4.83	6.31	7.99	9.86	12.50	15.41

### Unit weight of standard reinforcing steel bars

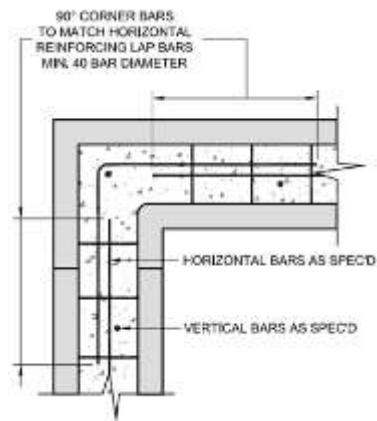
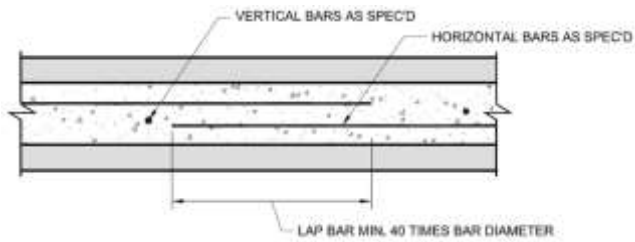

$$\text{Unit Weight of } \phi \text{ Bar} = \frac{\phi^2}{18^2} \times 2 \text{ (kg/m)}$$



**Example:**

Find reinforcement bars quantities and weight for the following items:

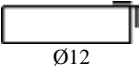
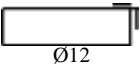
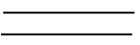
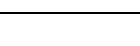
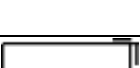
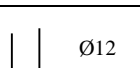
1. Footings. 2. Walls. 3. Columns. 4. Slabs

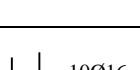
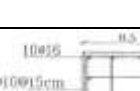
Item	Work Description	Reinforcement Bar Shape	Bars Length	Number of Bars	Total Length	Weight per 1 m.r	Total Weight
1.1	Footing 2	 Ø12	$(3.8-.08+0.6-.08) \times 2 + .2 = 7.24$	$(2.9-.08) / .15 + 1 = 20$ 20x1=20	144.8	0.888	128.6 kg
		 Ø12	$(2.9-.08+0.6-.08) \times 2 + .2 = 6.88$	$(3.8-.08) / .15 + 1 = 26$ 26x1=26	178.9	0.888	158.8 kg
1.2	Continuous footing section 1-1 (30 m)		6	$30 / (6-50 \times .012) = 5.5$ 5x12=60	360	0.888	319.7 kg
			$30 - (5.4 \times 5) = 3$ m $3 + 0.6 = 3.6$ m	12	43.2	0.888	38.4 kg
			$(1.2-.08+.6-.08) \times 2 + .2 = 3.5$ m	$30 / .2 = 150$	525	0.888	466.2 kg
2.	Walls (length 30 m x height 4 m x thickness 0.3 m)	 Ø12	$4 + .55 + .6 = 5.15$	$2 \times 30 / .2 = 300$	1545	0.888	1,372.0 kg
		 Ø12	6	$2 \times (4 / .2 + 1) = 42$ $42 \times 5.5 = 231$	1386	0.888	1,230.8 kg
3.	Columns C1 (height 4 m, 2 columns)	 10Ø16	$4 + .55 + .6 = 5.15$	$10 \times 2 = 20$		1.58	
	C1 Stirrups		$(.45 + .25) \times 2 + .1 =$ $(.15 + .25) \times 2 + .1 =$	$4 / .15 =$		0.617	

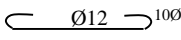
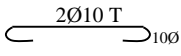
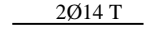
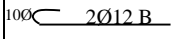
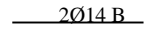
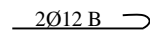
			$(.45+.13) \times 2 + .1 =$				
4.	<b>Slabs</b>						
	Solid Slab		$3.1+.3+.12+.12 =$ $3.8+.3+.12+.12 =$	$2 \times 3.8/.15 =$ $2 \times 3.1/.15 =$		0.888	
	Ribbed Slab (B,C)		$10-.3+.1+.1 =$ $10+3.7-.3+.1+.1 =$	$2 \times 4 =$ $2 \times 12 =$		0.617	
							
							
							
							
	Ribbed Slab (D,E)						
	B1						
	B2						
	B4						
	CR						
	DR						

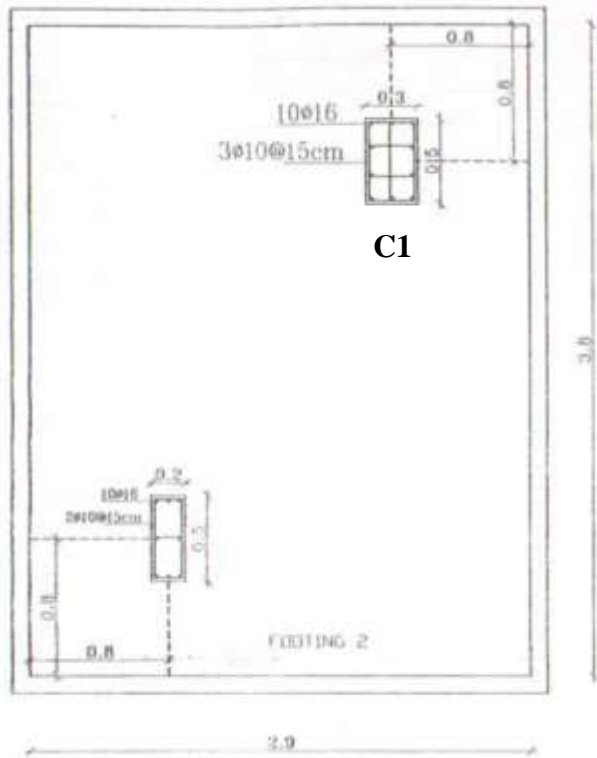

Assume concrete covering is 4cm.

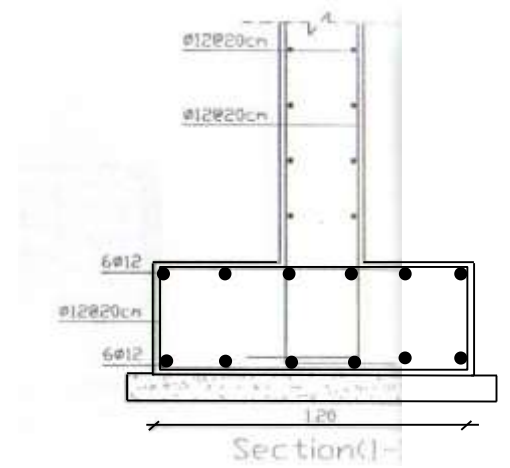

Assume the length of continuous footing is 30 m.

Assume required reinforcement overlapping equals 50 times the bar diameter.

For  $\phi 12$ mm it equals 0.60 m

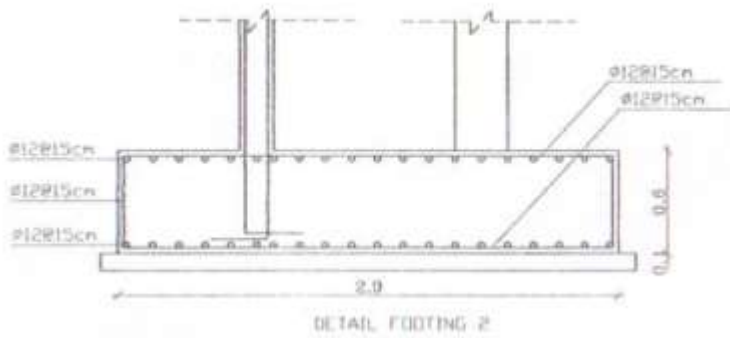



## 2.8 Plastering (أعمال القسارة)

المشروع: مبنى كلية الهندسة / جامعة الزيتونة					
الرقم	نوع العمل	وحدة الكيل	الكمية	السعر	
				دينار	فلس
		المبلغ			
		دينار	فلس		
4	أعمال القسارة: مقدمة:				
1/4	ارتفاع الشرائح و الزوايا المعدنية المستعملة في بند القسارة تكون بكامل ارتفاع الطابق أو بكامل العرض في حالة التقاء جدران الطوب بالسقف و الجسور الخرسانية و في حال استعمال الشرائح و جدران الطوب تكون بكامل طول القمط.				
أ-	تقديم و عمل قسارة إسمنتية من مونة الإسمنت و الرمل مضافاً إليها المواد المميعة حسب البند 1/702 و السعر يشمل الزوايا المعدنية للزوايا الداخلية و الخارجية و الشرائح المعدنية و زوايا توقف القسارة حسب البند 1/702 و : ثلاثة وجوه قسارة داخلية للأسقف و الجدران و حيثما يلزم حسب البند 702 و الكيل حسب البند 1/711 و تكال سلالات الشبائيك قسارة داخلية.	متر مربع			
ب-	ملاحظة هامة: الأسقف التي تحتوي على أسقف مستعارة لا يطلب من المقاول قسارتها قسارة خارجية أربعة وجوه، الوجه الرابع رشة شبريز و حسب الألوان و النقشة التي يحددها المهندس و ذلك للتصوينات و حيثما يلزم و حسب البند 705 و الكيل حسب البند 3/711 و السعر يشمل إضافة مواد مانعة للنش و كل ما يلزم من مواد و أدوات و سقالات و أيدي عاملة لإنهاء العمل على أكمل وجه و بموافقة المهندس.	متر مربع			
2/4	كالبنء رقم 1/4 من أعمال القسارة. و لكن قسارة خارجية ثلاثة وجوه للجدران التي خلفها طمء. (قسارة عربية)	متر مربع			

### 711 الكيل و شمولية الأسعار

1/711 تكال القسارة الأسمنتية الداخلية و الخارجية بالمرء المربع كلاً هندسياً، و تضاف مساحات سلالات الأبواب و الشبائيك و البروزات، و تحسم الفراغات مثل النوافذ و الأبواب و الفتحات التي تزيد مساحة أي منها عن 0.5 متر مربع. و يكون السعر شاملاً الطرشة (المسمار) و البطانة و الظهارة و السقالات بدون أية علاوة للحواف.

المثل لقسارة الشبريز و القسارة المانعة للرتوبة و قسارة الشبك المعدني

6/711 تكال الشرائح الشبكية و القضبان فوق التمديدات و مناطق اتصال الجدران و الزوايا و الحواف و النهايات بالمرء الطولي كلاً هندسياً بدون احتساب مناطق التراكم، و يكون السعر شاملاً الشرائح و المسامير و التثبيت و السقالات.

- هذه الطريقة في المواصفات العامة لن يؤخذ بها في المشروع بسبب وجود مواصفة في المواصفات الخاصة لشمول الزوايا و الشرائح المعدنية ضمن القسارة العادية.

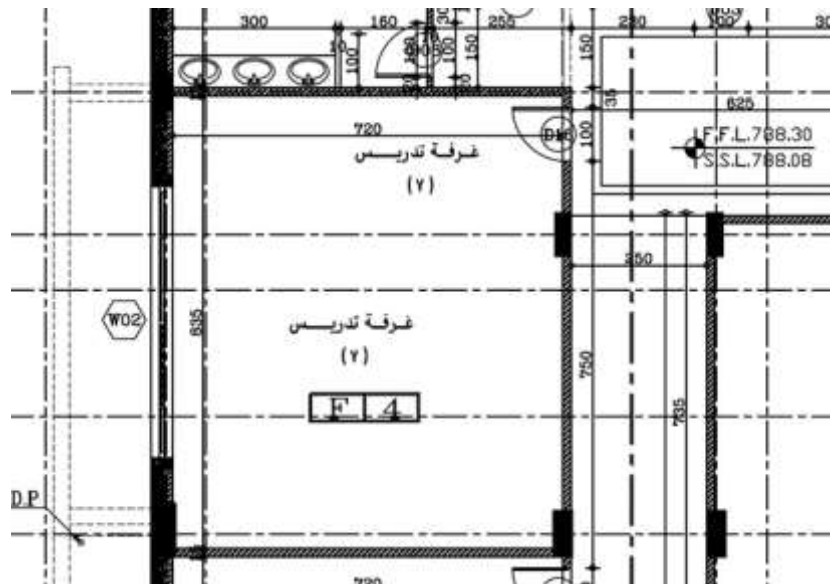

جدول التفصيلات

الارتفاع	الأرضيات	جدران	أسقف	بوابل
F1	الأرضيات بالأسفلت أو رابع معدل المساحة	سماط مسطوح	الحصين	جدران مسطوح
F2	رقة السور، الحقل الراسي والبيوت المساحة	رصاص ايطالي لون بيج مع قلم RASC ANTIKOR	رؤبات FIBER SERRAL FIBER -الراجح صوم بريد و حسب المخططات	رصاص ايطالي
F3	درج معدل المساحة	رصاص ايطالي لون بيج	الحصين	رصاص ايطالي
F4	كاسي التدوير، سماط التدوير العالم خوف حبات، قاذية التدوير الكراسي مطوي قاذية، وكثيرة قاذية المشطبات (بالسقاء قاذية الحديد)	بورتلان سماط كورسكو 2. = 2. = 2.	رؤبات FIBER SERRAL FIBER -الراجح صوم بريد و حسب المخططات	بورتلان بارافانج -سد
F5	الاسمات، اليرقيه، الطبخ	الخشبي	سراج الطيور بالاسفلت العالم ولكن من (الاسفلت) العالم SERRAL FIBER -الراجح صوم بريد و حسب المخططات	
F6	سوات واسطحة، سوات حسب المساحة	بورتلان سماط كورسكو 2. = 2. = 2.	رؤبات FIBER SERRAL FIBER -الراجح صوم بريد و حسب المخططات	
F7	خوف التدوير، الحقل الراسي، رؤبات التدوير	بورتلان سماط كورسكو 2. = 2. = 2.	الحصين	بورتلان سماط
F8	الكورسكو	بورتلان سماط كورسكو 2. = 2. = 2.	الراجح صوم بريد و حسب المخططات + طساق حاسوبية	
F9	خروف المشاغل	خرساتة مغطاة مع سادة خضيه	الحصين بالاسفلت مشال الكاسي SERRAL FIBER -الراجح صوم بريد و حسب المخططات	سجاطك
F9	مشطبات الكورسكو	خرساتة مغطاة مع سادة خضيه	رؤبات صوم بريد و حسب المخططات 2. = 2. = 2.	سجاطك
F10	مشطبات الكورسكو	بورتلان سماط كورسكو 2. = 2. = 2.	اسفلت مستطارة حسب المخططات	بورتلان
F11	خروف التدوير	الحصين الخشب المشطبات العالم SERRAL FIBER -الراجح صوم بريد و حسب المخططات	اسفلت مستطارة حسب المخططات	طاطير (كاسي) PVC

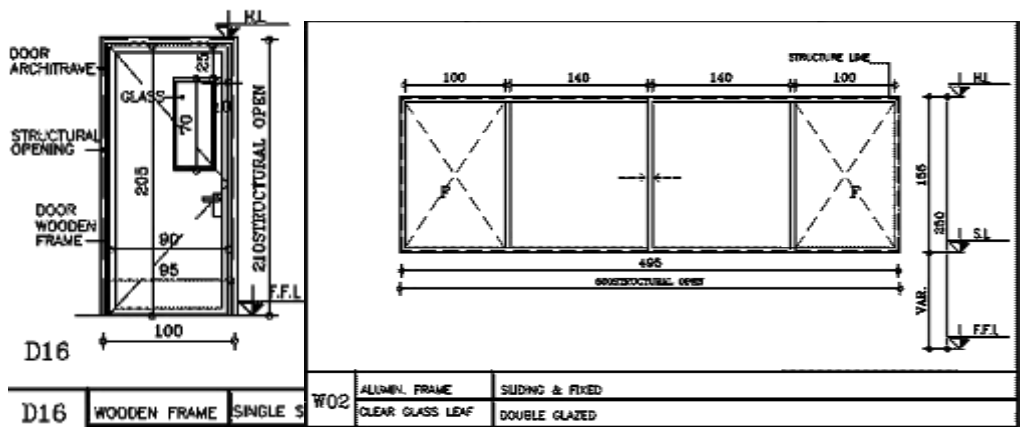

Description	Unit	No.	Dimensions			Sum	Note
			Length	Width	Height		
قسارة	متر مربع						
غرفة تدريس 7							
1		1	8.35		2.91	24.2985	
2		2	7.2		2.91	41.904	
3		1	8.65		2.91	25.1715	
سلاحات الشباك		2	1.55	0.3		0.93	
		1	5	0.3		1.5	
(الخصم)							
الباب		-1	1		2.1	-2.1	
الشباك		-1	5		1.55	-7.75	
					<b>Total=</b>	<b>83.954</b>	

## 2.9 Bricks (أعمال الطوب)

المشروع: مبنى كلية الهندسة / جامعة الزيتونة						
الرقم	نوع العمل	وحدة الكيل	الكمية	السعر		المبلغ
				فلس	دينار	
				فلس	دينار	
3	أعمال الطوب (Bricks): ملاحظة هامة: الطوب المطلوب يتم تصنيعه باستخدام مكابس أوتوماتيكية					
1/3	بالمتر المربع: تقديم و بناء جدران طوب خرساني مفرغ صنف عادي (أ) و حسب بند 603 الباب السادس خرسانة عادية و قوة كسر لا تقل عن 3.5 نيوتن/ملم <sup>2</sup> بعد 28 يوم و الكيل حسب بند 1/620 و شمولية السعر حسب بند 1/619 و المونة حسب بند 607 و السعر يشمل عمل القموط و السلاحات و الجلسات الخرسانية من خرسانة درجة (20) شاملاً حديد التسليح و بدون أي علاوات					
أ-	سماكة 10 سم	م <sup>2</sup>				
ب-	سماكة 15 سم	م <sup>2</sup>				
ج-	سماكة 20 سم	م <sup>2</sup>				
د-	جدران من طوب خرساني مزدوج و حسب متطلبات بند 2/608 و المرابط حسب بند 1/610 أ و الكيل حسب بند 1/620 و شمولية السعر حسب بند 1/619 من الباب السادس. و ذلك ل: أ- طوب مزدوج قياس (10 + 10 فراغ + 10) سم	م <sup>2</sup>				
2/3	بالمتر المربع: تقديم و بناء جدران طوب اسمنتي مصمت للجدران التي خلفها طمم و حسب متطلبات ج/3/603 من الباب السادس و الكيل حسب بند 1/620 و شمولية السعر بند 1/619 من الباب السادس. سماكة (10) سم	م <sup>2</sup>				
3/3	بالعدد: تقديم و صف طوب مفرغ للعقدات و حسب بند 1/325 و الكيل حسب بند 6/327 و شمولية الأسعار حسب بند 6/328 من الباب الثالث بالإضافة إلى استعمال طوب مسدود للجوانب. قياس (30 x 20 x 40/36) سم.	عدد				
4/3	بالمتر المكعب: تقديم و تركيب بلوكات بوليسترين صناعة سعودية بدل الطوب الخرساني لعقدة القاعة المتعددة الأغراض ضمن عقدة الطابق الأرضي و الموضحة على المخططات كثافة 25 كغم/م <sup>3</sup> و يشمل السعر تثبيت البوليسترين بشكل يضمن عدم إزاحته أثناء الصب، و عمل كل ما يلزم و حسب المخططات و المواصفات و تعليمات المهندس المشرف	م <sup>3</sup>				

### 619 شمولية الأسعار

1/619 تعتبر الأسعار الفردية المنصوص عليها في جدول الكميات لأعمال بناء جدران الطوب شاملة لكل ما يلزم من مواد و مصنعية ، من حيث توريد الطوب من الصنف المنصوص عليه ، و تركيبه ، و الأيدي العاملة ، و السقالات ، و الملاط ، و المرابط ، و غير ذلك مما يلزم لإنجاز الأعمال على أكمل وجه و حسبما ورد في هذه المواصفات.

- قد يكون هناك في المواصفات الخاصة علاوات على القموط أو السلاحات أو الشناجات الخرسانية أو على استخدام المرابط في الجدران المزدوجة.

### 620 الكيل

1/620 تكال جدران الطوب كياً هندسياً بالمتر المربع لواقع الواجهات التي جرى بناؤها بالموقع بعد حسم جميع الفراغات، و الفتحات، و الثغرات التي تزيد مساحتها عن (0.10) متراً مربعاً، على أن يكون الكيل للجدران المجوفة (المزدوجة) من جهة واحدة فقط.

- لغايات دفع العلاوات، تكال الأعمال التي لها علاوات بالمتر الطولي.

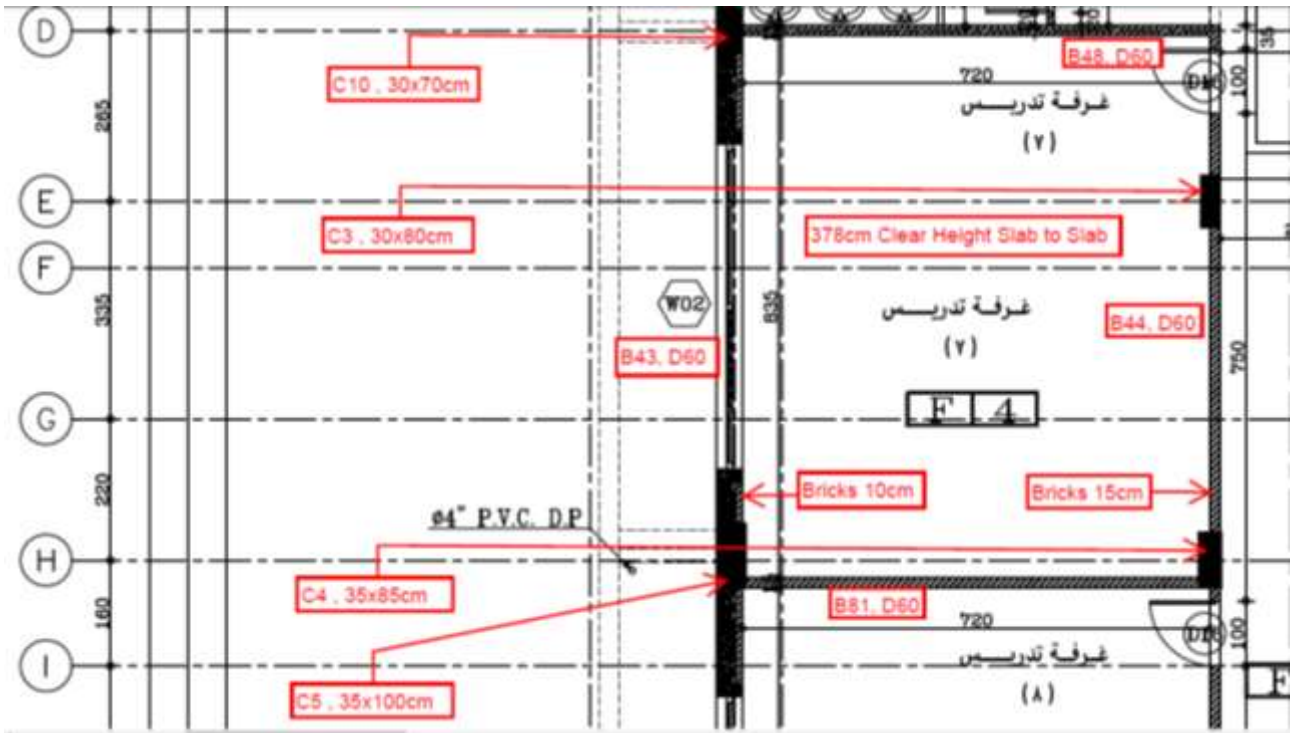

Description	Unit	No.	Dimensions			Sum	Note
			Length	Width	Height		
أعمال الطوب							
غرفة تدريس 7							
جدران طوب خرساني مفرغ	متر مربع						
سماكة 10 سم							Length=
1		1	7.35		3.18	23.373	2.2+3.35+2.65-0.5-0.35
(خصم الشباك)		-1	5			-5	Hight=
							المجموع 18.373
سماكة 15 سم							3.56+0.22-0.6
2		1	7.35		3.18	23.373	L=7.2+.15
3		1	6.85		3.18	21.783	L=8.35+.15-.85-.8
4		1	6.95		3.18	22.101	L=7.2+.15-.35-.05
(خصم الباب)		-1	1		2.1	-2.1	
							المجموع 65.157
طوب العقدة (طوب الربس)	عدد	442				442	L of Rows=6.6+.75-.15-.15-.2=6.85≈6.8m
One-way Ribbed Slab							N of Rows=13
							N of Blocks in 1m= 5
مدخل مبنى عمادة الهندسة							
طوب العقدة							
Two-way Ribbed Slab	عدد	480				480	N of Squares= 15 x 16
							N of Block in each Square= 2
القاعة متعددة الأغراض							
بلوكات بوليسترين للعقدات	متر مكعب	201.5	0.8	0.8	0.6	77.376	N=15.5 x 13

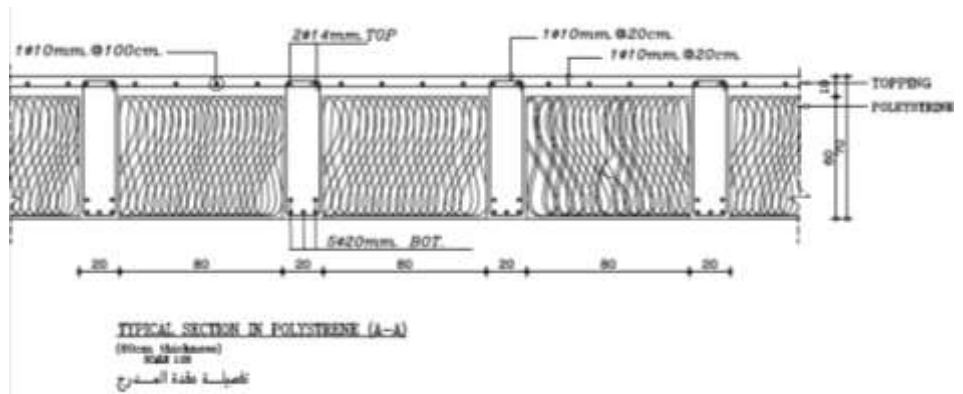
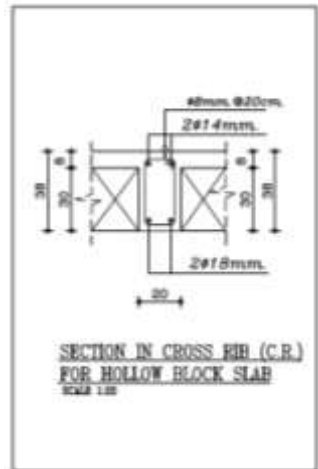
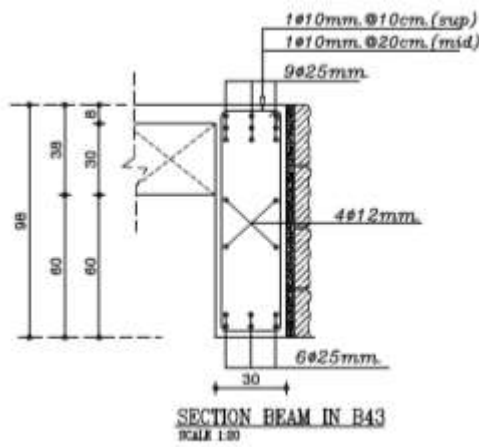
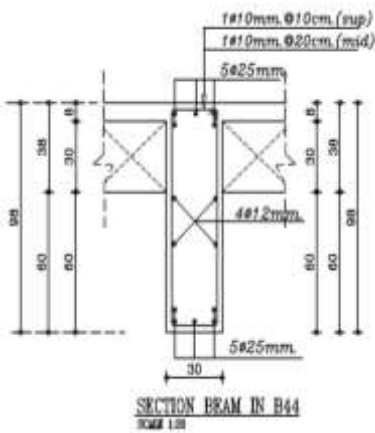
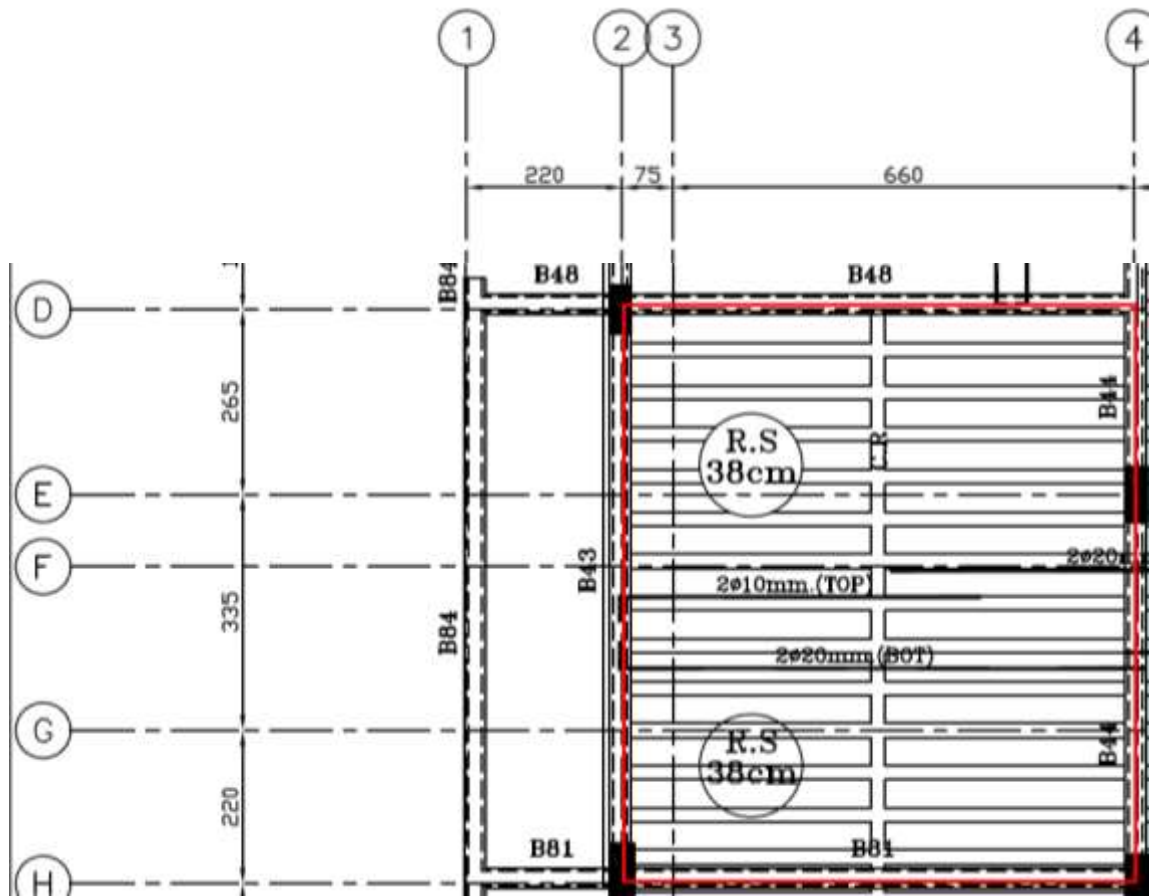

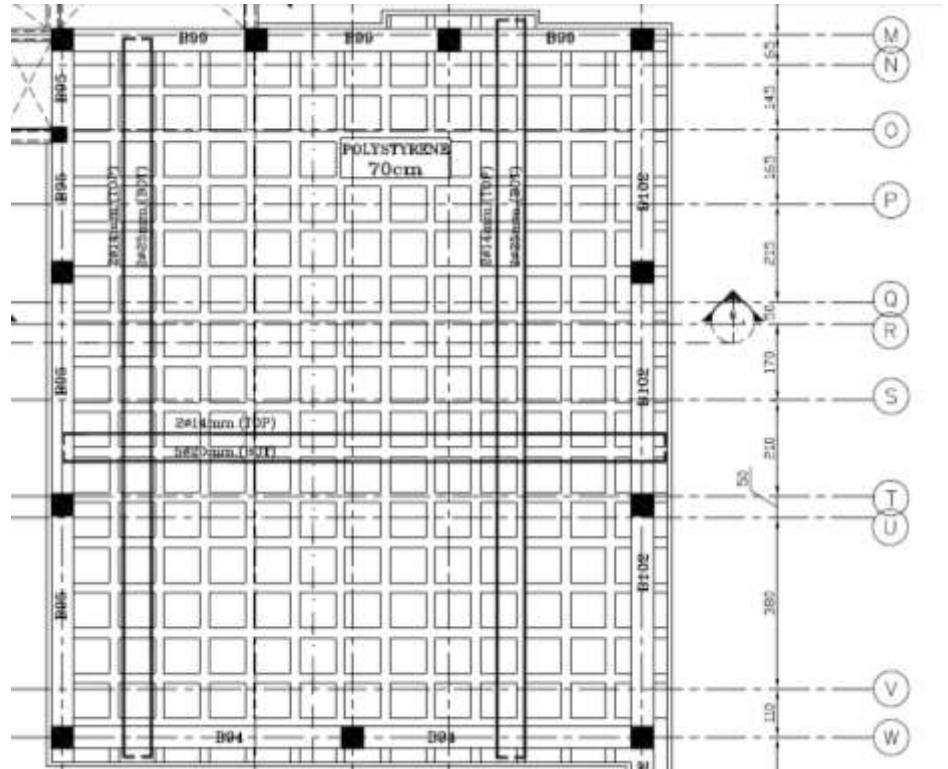
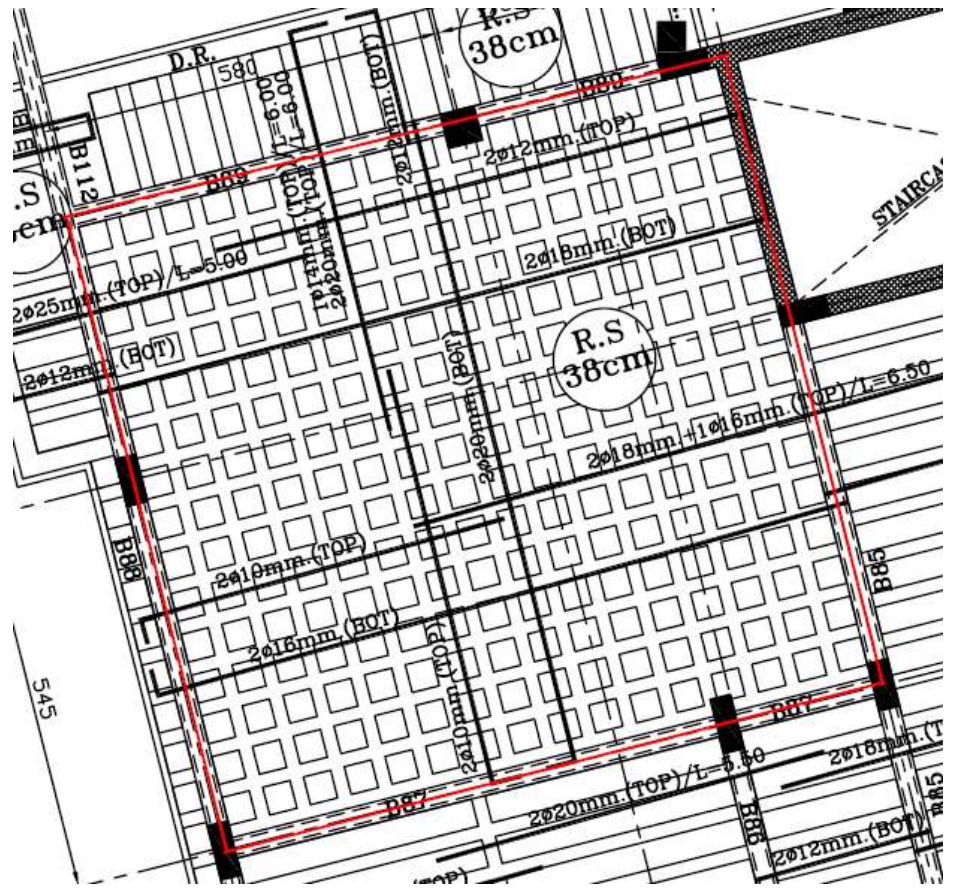

## 2.10 Masonry Work (أعمال الجدران الحجرية)

المشروع: مبنى كلية الهندسة / جامعة الزيتونة					
الرقم	نوع العمل	وحدة الكيل	الكمية	السعر	
				فلس	دينار
المبلغ		فلس		دينار	
	أعمال الجدران الحجرية:				
	بالمتر المربع: تقديم و بناء جدران حجرية (بناء أو تلبيس) صنف أ درجة أولى و متجانس الألوان من حجر معان (سطح معان) أبيض نخب أول مداميك ارتفاع (25) سم بسماكة 5 سم بعد الدق خال من العيوب الواردة في بند 503 و حسب متطلبات بند 1/502 الباب الخامس حسب متطلبات بند 505 ، 1/504 ، 509 ، 508 ، 507 ، من مواصفات وزارة الأشغال العامة و الإسكان ، و نقشة الحجر حسب المخططات (مفجر أو مطبة أو مسمم) و حسب العينة المقدمة و المعتمدة من المهندس المشرف. ولا يشمل السعر خرسانة الأعمدة أو خرسانة الجسور أو العقدات أو خرسانة الجدران المسلحة حيث أن هذه الأعمال الواقعة خلف الحجر و حسب القوة المطلوبة في المخططات واردة في بنود القسم الثاني من هذه الجداول. و يشمل السعر خرسانة التصفيحة خلف الحجر بقوة كسر لا تقل عن 200 كغم/سم <sup>2</sup> بعد 28 يوم. و يشمل السعر أيضاً المونة حسب متطلبات بند 506 و الكحلة حسب بند 512 ، و الكيل حسب بند 1/518 و شمولية السعر حسب بند 1/517 و 2/517 ، و حسب المواصفة القياسية الأردنية رقم 851 لعام 1992 ، المرفقة بالشروط الخاصة و السعر يشمل جميع علاوات الحجر و تشكيلاته و لا يحق للمقاول المطالبة بأية علاوات أو أسعار إضافية و يعتبر سعره شاملاً لجميع تلك العلاوات و التشكيلات. و الكيل لمساحات الواجهات فقط و بدون احتساب الجوانب و البروزات و سلاحات و قمطات و برابيش و غيرها (الكيل للمسقط الشاقولي لواجهات الحجر). ملاحظة: يكون حديد التسليح (WELDED MESH) قطر (6) ملم/20سم بالاتجاهين خلف الحجر لمناطق تلبيس الحجر و الدسر من الحديد المجلفن والتي يتم تثبيتها بشكل محكم و حسب الأصول و محملة على الأسعار أعلاه و لا تكال و لا تدفع أي علاوات مقابل تنفيذها.	م <sup>2</sup>			
	كالبند السابق و لكن حجر مداميك ارتفاع (51) سم ، سماكة الحجر لا تقل عن (4) سم مع ضرورة تخشين الوجه الخلفي الملاصق للخرسانة.	م <sup>2</sup>			
	كالبند السابق و لكن حجر تفوح لون أصفر مداميك ارتفاع (51) سم.	م <sup>2</sup>			
	ملاحظة: تكون عملية البناء بأسلوب بناء الحجر ثم الصب خلفه بطريقة الطوبار و على أن يتم بناء الطوب و تثبيت العازل الحراري خلال عملية تقطيع الطوب و بعد معالجة أي عيوب تظهر في الخرسانة بعد فك الطوبار و حسب ما هو موضح على المخططات. - و لا يشمل سعر بند الحجر أعمال الطوب و العازل الحراري الذي يتم تثبيته بالطوب حيث أن هذه الأعمال واردة ضمن بنود العطاء				
	بالمتر المربع: تقديم و تركيب جبه حجرية من حجر معان نخب أول صلب خال من العيوب الحجرية مدفوق بالمطبة الناعمة سن (14) و السعر يشمل المونة و الكحلة طلس بالإسمنت الأبيض و المرابط و الدسر و كل ما يلزم لإنجاز العمل على أكمل وجه حسب المخططات و المواصفات، بأطوال متفاوتة لا تقل عن 45 سم و بسماكة 5 سم.	م <sup>2</sup>			



	حجر معان مدامك 15
	حجر تفوح مدامك 5
	واجهات زخايفة
	حجر معان مدامك 50
	خزائناتية وسيمية
	البوابات حديد
	الكوبونيد

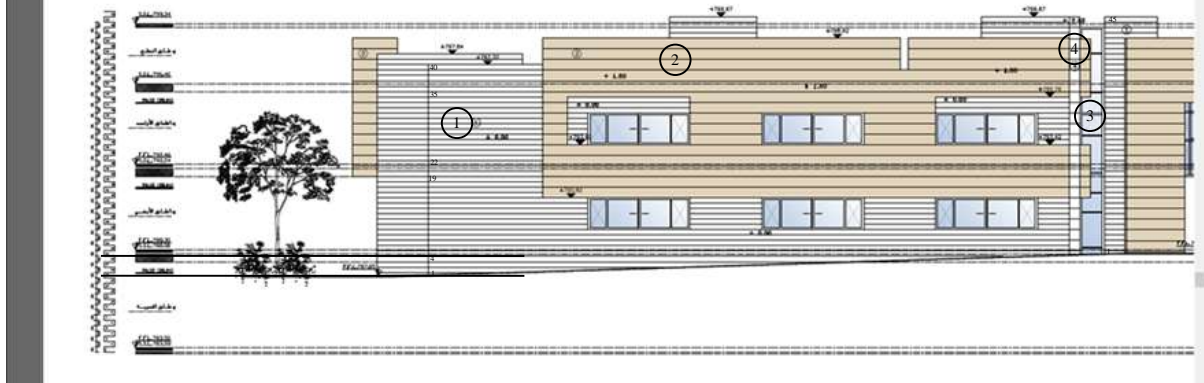
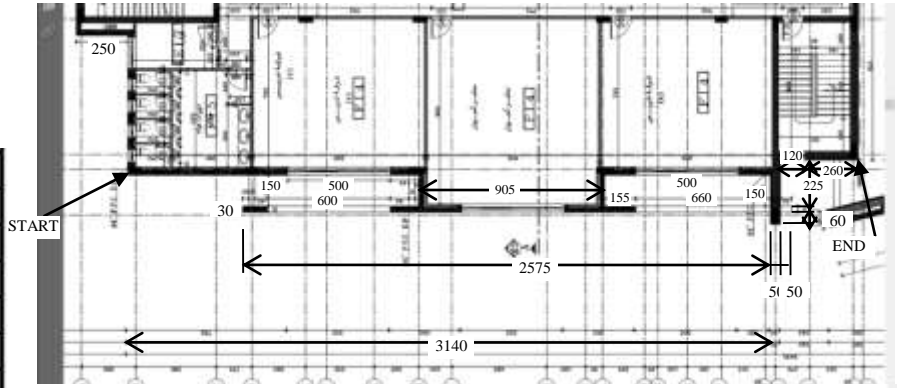

Description	Unit	No. of Rows	Dimensions			Sum	Note
			Length	Width	Height of Stone		
أعمال الجدران الحجرية							
حجر معان مدامك ارتفاع 25 سم	متر مربع	38	31.4		0.26	310.232	
بيت الدرج		45	2.6		0.26	30.42	
(خصم بروز مختبر الكمبيوتر في الطابق الأول)		-21	9.05		0.26	-49.413	
(خصم الشبانيك)		-5	5		1.56	-39	No. of Windows=5
							Height of Window=6x0.26
					<b>Total=</b>	<b>252.239</b>	
حجر معان مدامك ارتفاع 51 سم	متر مربع	22.5	0.5		0.52	5.85	
		22.5	3.15		0.52	36.855	
		22.5	2.4		0.52	28.08	
(خصم تقاطع حجر التفوح الأصفر مع حجر معان)		-10.5	0.3		0.52	-1.638	
		-10.5	0.3		0.52	-1.638	
					<b>Total=</b>	<b>67.509</b>	
حجر تفوح أصفر مدامك ارتفاع 51 سم	متر مربع	15	25.75		0.52	200.85	
		10.5	0.5		0.52	2.73	
إضافة جوانب الشراع الأصفر الأيسر		15	0.3		0.52	2.34	
إضافة جوانب الشراع الأصفر الأيمن		10.5	0.3		0.52	1.638	
إضافة أسفل الشراع الأصفر			26.25	0.3		7.875	
(خصم الفتحة اليسرى)		-4.5	6		0.52	-14.04	
(خصم الفتحة اليمنى)		-4.5	6.6		0.52	-15.444	
(خصم فتحة على السطح)		-3	0.4		0.52	-0.624	
إضافة جوانب الفتحات		3		0.3	2.34	2.106	عدد الجوانب=3 ارتفاع الجوانب=4.5x0.52
إضافة أعلى الفتحات			13.1	0.3		3.93	عرض الجوانب=0.3
إضافة جوانب الفتحة على السطح		2		0.3	1.56	0.936	أعلى الفتحات=0.5+6.6+6
					<b>Total=</b>	<b>192.297</b>	
في هذا المثال افترضنا تقريبا أن جميع الأماكن المخفية عن الأنظار للمنظر الخارجي للمبنى هي غير حجرية							